



Estimate

ADDRESS

SGM DOORS AND TRIM

ATTN: JESUS BARRON

RE: MANSIONS AT MARINE CREEK

ESTIMATE

11210

DATE

03/17/2024

SALES REP

CHRISTINA 619-635-2888

ACTIVITY	DESCRIPTION	QTY
MATERIAL- EXPENSE	PLASTIC LAMINATE PER ATTACHED	
STYLE	FLOOR MOUNTED/OVERHEAD BRACED	
HARDWARE	HARDWARE INCLUDED PER ATTACHED	
COLOR	STANDARD COLOR INCLUDED	
STALLS	INCLUDED IN PROPOSAL	4
SCREENS	INCLUDED IN PROPOSAL	1
CAN SHIP IN	APPROX. 2 WEEKS (MAY CHANGE DEPENDING ON COLOR)	
STANDARD FREIGHT INCLUDED	BASED ON (1) SINGLE SHIPMENT TO 75201	

*** SALES TAX WILL BE ADDED IF SHIPPING TO CA, TN, TX, OK, NY, FL, GA, MA, NJ, WA,
AZ, MI, MN, NC, VA, IL AND MD.

• QUOTES ARE VALID FOR 30 DAYS
• QUANTITIES & DESCRIPTIONS NOT GUARANTEED TO AGREE WITH PLANS AND/OR
SPECS. IT IS YOUR RESPONSIBILITY TO REVIEW ENTIRE QUOTE/SUBMITTAL PRIOR TO
BIDDING YOUR PROJECT. YOU ARE ALSO RESPONSIBLE FOR VERIFYING LOCAL
MUNICIPALITY / CODE COMPLIANCE.
ANY CHANGES MADE CAN IMPACT PRICING.

TOTAL

\$4,670.00

Accepted By

Accepted Date

Shipping Information (PLEASE MARK ALL THAT APPLY):

- 
- ☐ Ship ASAP
 - ☐ Do NOT Ship Before Date ____/____/____
 - ☐ Lift Gate Fee Add. \$125.00
(REQUIRED IF NO FORKLIFT OR LOADING DOCK)
 - ☐ Residential / Non-Commercial Delivery Add. \$95.00*
 - ☐ Notification call prior to delivery Add \$40.00

APPROVED: _____

*** The term "residential/non-commercial" also includes apartments, places of worship, schools, pre-schools, day cares, camps, farms, public storage facilities, business operating within a private residence, and other such locations not generally recognized as commercial locations and shall apply to the entire premises.**



Technical Data

DesignerSeries™

High Pressure Laminate Partitions and Screens

1040 SERIES

SPECIFICATION

Height: 58" (1473mm) Doors and Panels with 12"(305mm) Floor Clearance

MATERIAL

Stiles* — 1" (25mm) finished thickness: 3-ply, 45-lb (20.4-kg) density, resin-impregnated particle board is bonded to each side of 11-gauge (3.2mm) sheet steel that serves as reinforcing core; surfaces and edges are .050" (1.3mm) thick, high-pressure plastic laminate with colored face sheets and matte finish.

Standard Size Stiles:

- For compartments — 3", 4", 5", 6", 7", 8", 10", 12", 16", 18", 20", or 24" (76, 102, 127, 152, 179, 203, 254, 305, 406, 457, 508, 610mm) wide.
- For screens — 6" (152mm) wide.
- Floor-anchored — 69" (1753mm) high.
- Overhead-braced — 83" (2108mm) high.
- Floor-to-ceiling anchored — height as required.
- Ceiling-hung — 83" (2108mm) high for 96" (2438mm) ceilings or as required up to 120" (3048mm) ceilings.

Panels — 1" (25mm) finished thickness: 3-ply, 45-lb (20.4-kg) density, resin-impregnated particle board; surfaces and edges are .050" (1.3mm) thick, high-pressure plastic laminate with colored face sheets and matte finish.

Standard Size Panels:

- For compartments — Up to 84" (2134mm) wide; 58"(1473mm) high.

Urinal Screens —1" (25mm) finished thickness: 3-ply, 45-lb (20.4-kg) density, resin-impregnated particle board; surfaces and edges are .050" (1.3mm) thick, high-pressure plastic laminate with colored face sheets and matte finish.

Standard Size Urinal Screens:

- For wall-hung screens — Up to 24" (610mm) wide; 42" to 54" (1067 to 1372mm) high.
- For ceiling-hung, floor anchored and post-to-ceiling screens — Up to 60" (1524mm) wide; 58" (1473mm) high.

Doors — 1" (25mm) finished thickness: 3-ply, 45-lb (20.4-kg) density, resin-impregnated particle board; surfaces and edges are .050" (1.3mm) thick, high-pressure plastic laminate with colored face sheets and matte finish.

Standard Size Doors:

- Inswing and outswing doors are standard 22" to 37" (559 to 940mm) wide; 58" (1473mm) high.

Posts (for 1043 Series screens only) — 1 1/4" (32mm) square tubing; 18-8, Type-304, 18-gauge (1.2mm) stainless steel with satin finish. Floor and ceiling connections are constructed of 18-8, Type-304, heavy-gauge stainless steel. Furnished in 120" (3048mm) lengths; to be cut in field to job specifications.

Standard Size Post:

- For 1043 Series post-to-ceiling screens only. 1 1/4" (32mm) square. 120" (3048mm); cut to required height in field.

Headrail (for 1042 Series compartments only) — Extruded anodized aluminum. Enclosed construction with sloping top. Face has raised grip-resistant edge.

Designer's Notes:

- Headrails with integral curtain tracks and hooks are available for compartments without doors. Optional vinyl curtains are available.

Wall Posts — 1" by 1 1/2" (25 by 38mm) wide tubing; 18-8, Type-304, 16-gauge (1.6mm) stainless steel with satin-finish. 58" (1473mm) high, pre-drilled for door hardware.

TOP VIEW OF 1042 (BARREL HINGE AND STANDARD BRACKET) INSTALLATION.

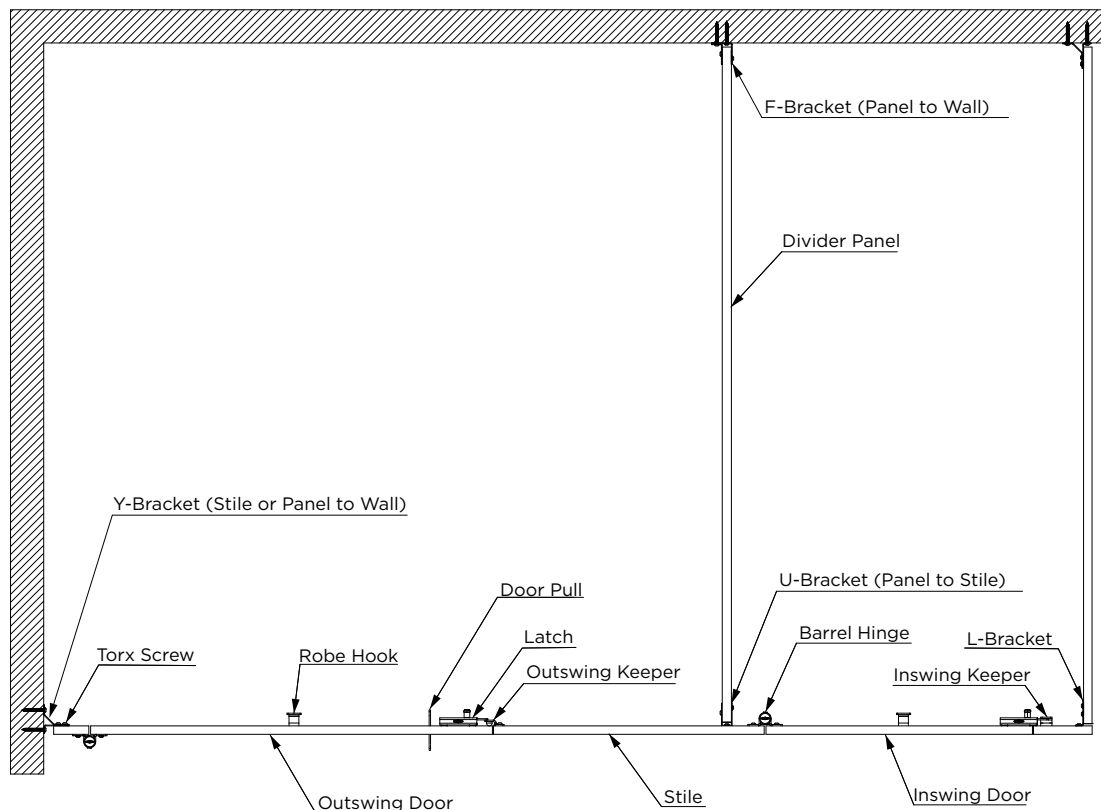

ANCHORING DEVICE:

Leveling Device — 3/8" x 7/8" (10 x 22mm) steel bar is welded to sheet-steel core of stile, forming a single structural unit; furnished with 3/8" (10mm) diameter threaded rods, hex nuts, lock washers, flat washers, expansion shields, and shoe retainers.

Shoe — 18-8, Type-304, 22-gauge (0.8mm) stainless steel with satin finish; 4" (102mm) high. *Stiles for 1046 Series floor-to-ceiling anchored have a leveling device at each end.

#1002701 FLOOR ANCHOR

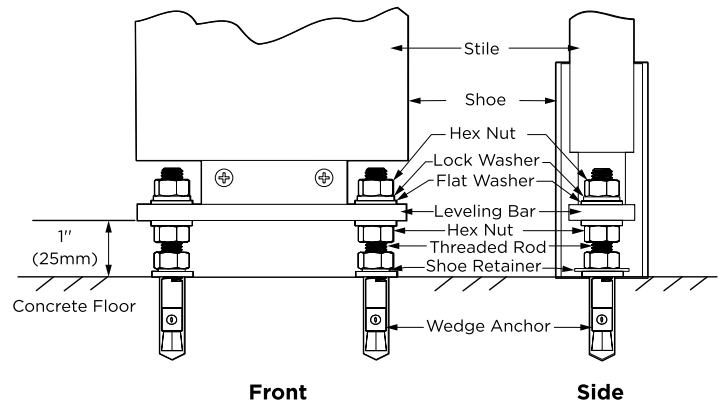

CEILING LEVELING DEVICE:

Provisions must be in the construction of the building to support ceiling-hung toilet partitions. Structure in ceiling, not furnished by Bobrick, must support at least 295 lb per high pressure laminate toilet compartment, and must be sufficiently rigid to withstand swinging motion of toilet partition doors and impact of doors against stiles. Actual mounting system, including lateral bracing, if required, must be designed by the architect or structural engineer, and furnished by others. Wood beams are not recommended for ceiling hung application.

Note: If adequate ceiling support cannot be provided, the floor-anchored or overhead-braced toilet compartments are recommended.

Approximate Weight: High Pressure Laminate Toilet Compartment - 295lbs.

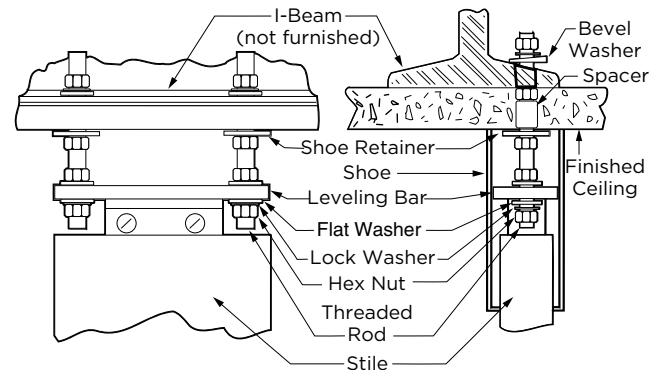

HEADRAIL INSTALLATION DETAIL

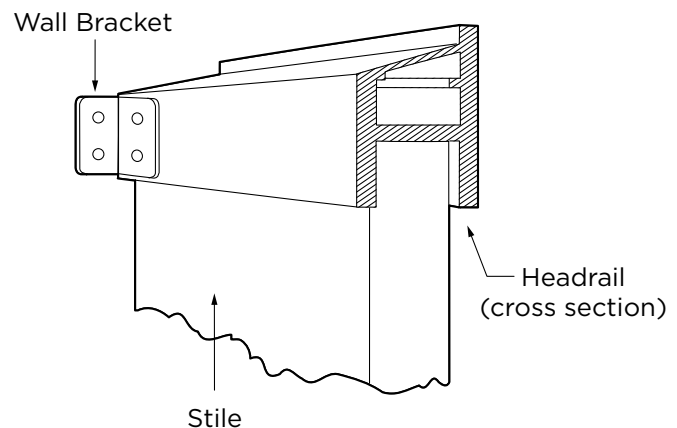

COMMERCIAL HARDWARE (STANDARD)

Hinges, door latch, door keepers, clothes hooks, mounting brackets and door handles are constructed of 18-8, Type-304, heavy-gauge stainless steel with satin finish.

Threaded inserts are factory installed for securing hinges and door latch. Theft-resistant, stainless steel pin-in-head, torx screws are furnished for door hardware and all mounting brackets.

Balanced hinge is adjustable to hold door of unoccupied toilet compartment partially open or fully closed.

Toilet compartment door is locked from inside by sliding door latch into keeper. A locked compartment may be opened from outside by lifting door to disengage latch from keeper. Track of door latch prevents inswing door from swinging out beyond stile; on outswing door, the door keeper prevents it from swinging in beyond stile. Door handles and latch have operable parts that are operable with one hand and do not require tight grasping, pinching, or twisting of the wrist; and comply with ADA Sections 404.2.7 and 309.4. The force required to activate the operable parts shall be 5 pounds (22.2N) maximum. Black rubber bumper on the latch serves as door bumper for inswing door.

#1040-42 LATCH ASSEMBLY

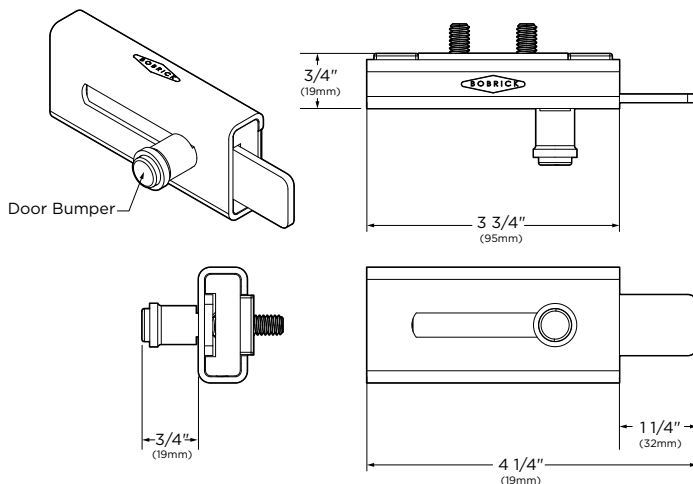

1040-35 KEEPER, INSWING

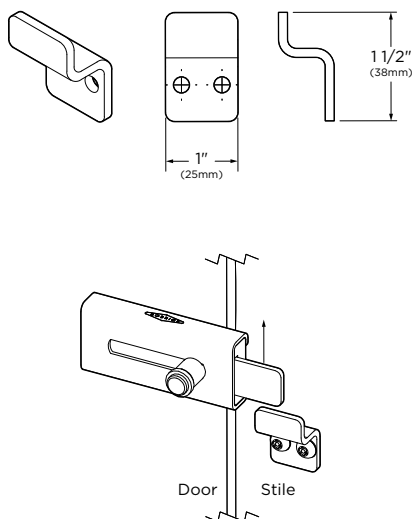

1040-36 KEEPER, OUTSWING

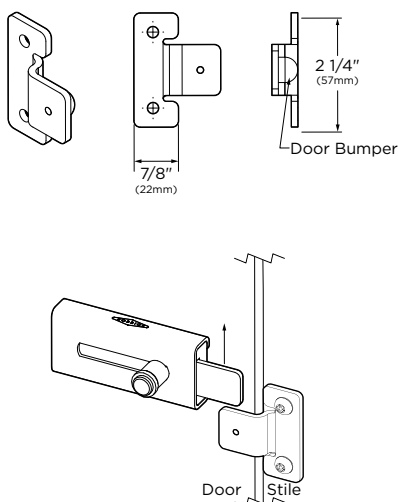

1040-39 PERPENDICULAR

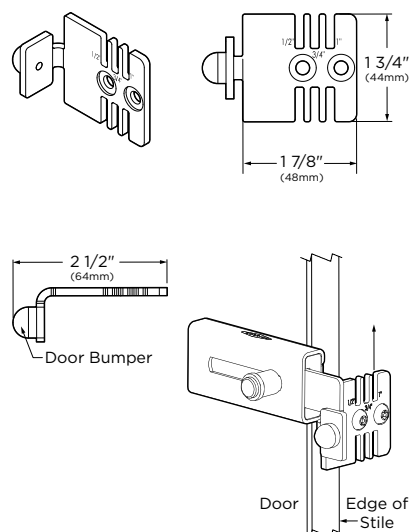

#1040-56 WALL MOUNTED KEEPER INSWING

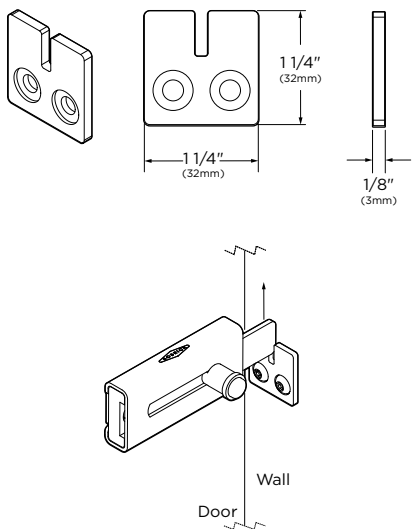

#1000869 COAT HOOK

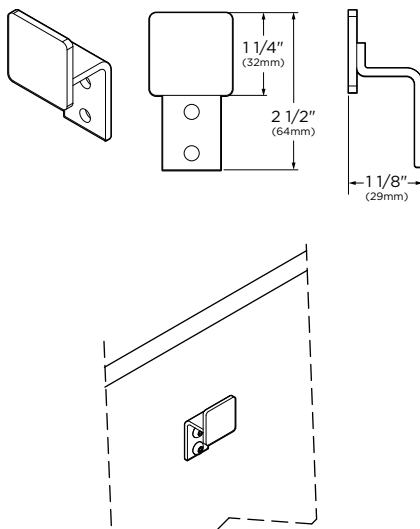

#1000312 DOOR PULL HANDLE

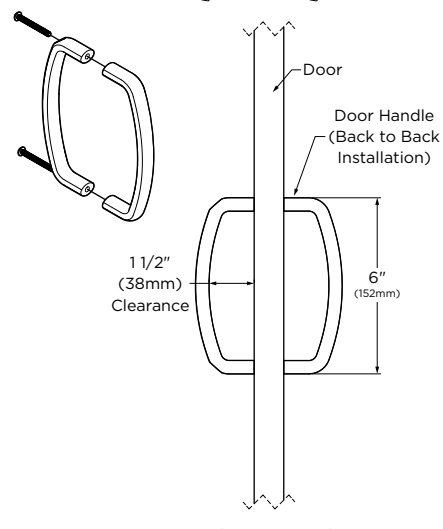

**#1002330
BARREL HINGE SET, L**

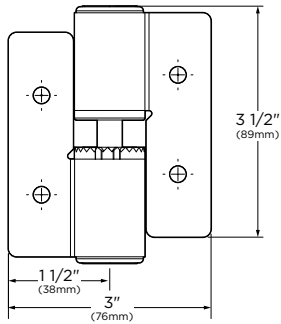

**#1002331
BARREL HINGE SET, J**

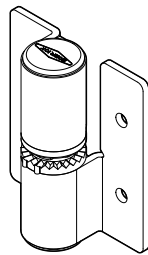
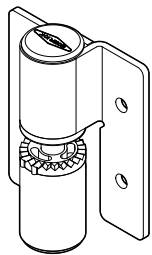
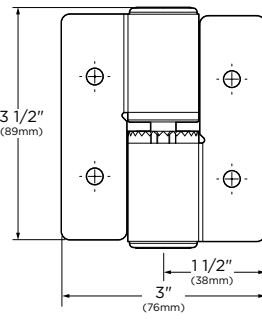

**#1002156
Hinge Cam**



Hinges are constructed of 18-8, Type-304, heavy-gauge stainless steel with satin finish. Threaded inserts are factory installed for securing hinges. Theft-resistant, stainless steel pin-in-head, torx screws are furnished for door hardware. Balanced hinge is adjustable to hold door of unoccupied toilet compartment partially open or fully closed.

CAM SETTINGS

**Door Beyond
Closed Position**

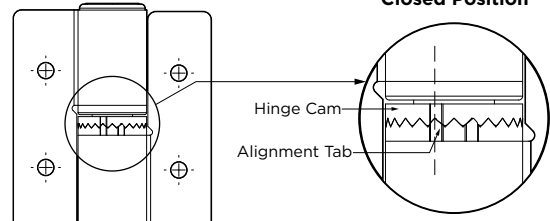

**Door Normal
Closed Position**

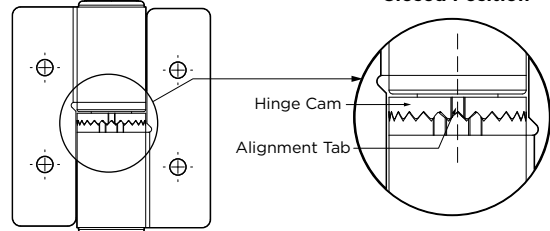

**Door Remain Open
15 Degrees**

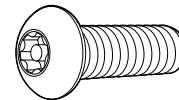
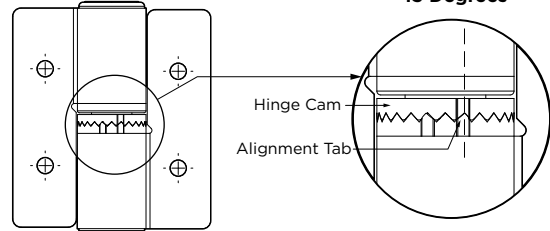

**#1002494
1/4-20 x 3/4"
Pin-in-Head Torx Screw**

BRACKETS (STANDARD):

**#1000351
L-Bracket
(Panel to Corner Stile)**

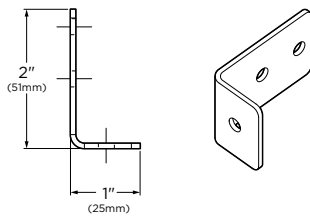

**#1000356
U-Bracket
(Panel to Perp. Stile)**

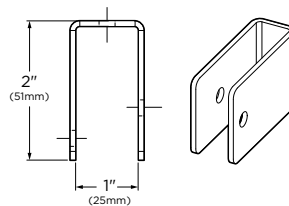

**#1002500
#12 x 3/4" Pin-in-Head Torx Screw
Panel/Stile Screw**

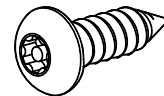

**#1000974
Y-Bracket
(Stile to Wall)**

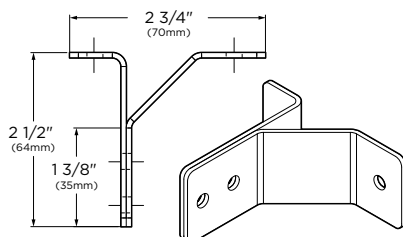

**#1000353
F-Bracket
(Panel to Wall)**

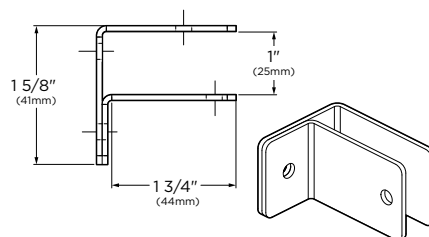

**#1002495
#12 x 2" Pin-in-Head Torx Screw
(M5.5 x 50mm) Wall Screw**

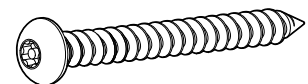

1041 SERIES FLOOR ANCHORED

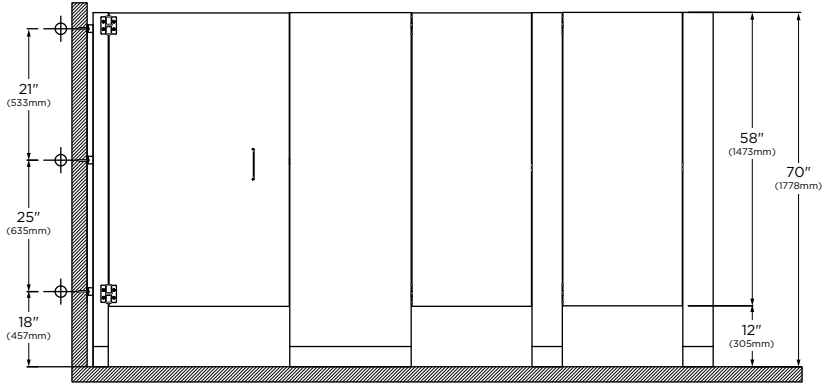

Front View

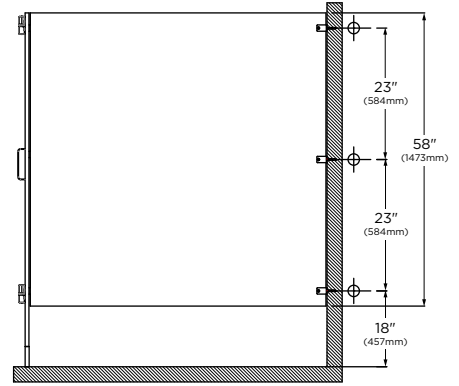

Side View

STANDARD:

- ☐ #1041 - Barrel Hinge and Standard Bracket

MODEL OPTIONS:

- ☐ #1041.65 - Continuous Hinge and Continuous Bracket
- ☐ #1041.65D - Continuous Hinge and Standard Bracket
- ☐ #1041.65DDS - Continuous Hinge, Standard Bracket and Door Stop
- ☐ #1041.65DS - Continuous Hinge, Continuous Bracket and Door Stop
- ☐ #1041.65P - Barrel Hinge and Continuous Bracket

1042 SERIES OVERHEAD-BRACED

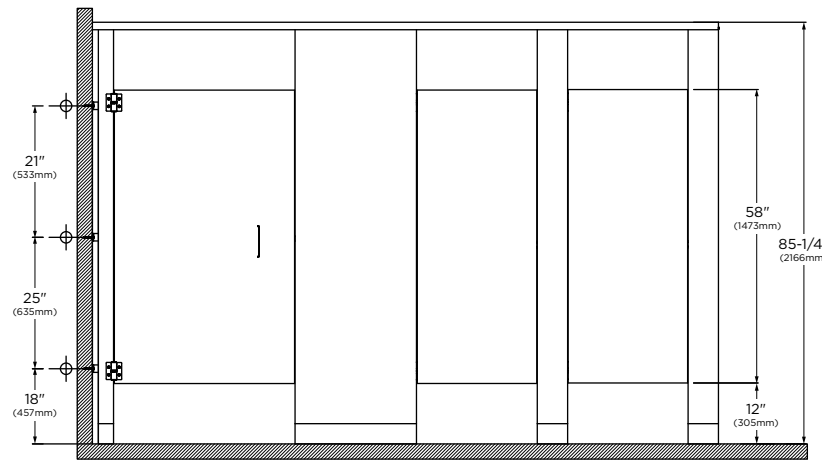

Front View

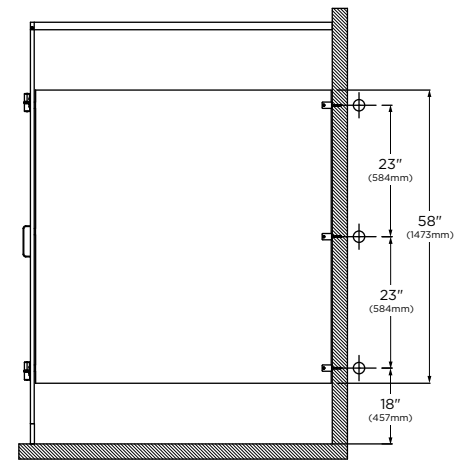

Side View

STANDARD:

- ☐ #1042 - Barrel Hinge and Standard Bracket

MODEL OPTIONS:

- ☐ #1042.65 - Continuous Hinge and Continuous Bracket
- ☐ #1042.65D - Continuous Hinge and Standard Bracket
- ☐ #1042.65DDS - Continuous Hinge, Standard Bracket and Door Stop
- ☐ #1042.65DS - Continuous Hinge, Continuous Bracket and Door Stop
- ☐ #1042.65P - Barrel Hinge and Continuous Bracket

1046 SERIES FLOOR-TO-CEILING

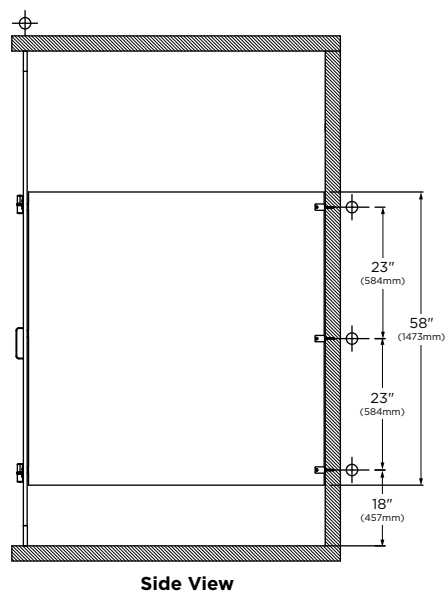
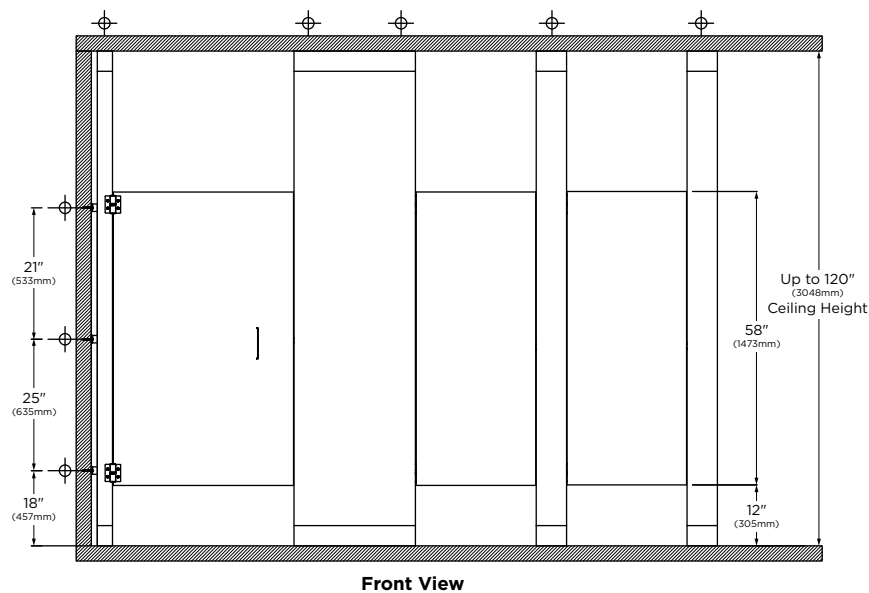

STANDARD:

- ☐ #1046 - Barrel Hinge and Standard Bracket

MODEL OPTIONS:

- ☐ #1046.65 - Continuous Hinge and Continuous Bracket
- ☐ #1046.65D - Continuous Hinge and Standard Bracket
- ☐ #1046.65DDS - Continuous Hinge, Standard Bracket and Door Stop
- ☐ #1046.65DS - Continuous Hinge, Continuous Bracket and Door Stop
- ☐ #1046.65P - Barrel Hinge and Continuous Bracket

1048 SERIES CEILING HUNG

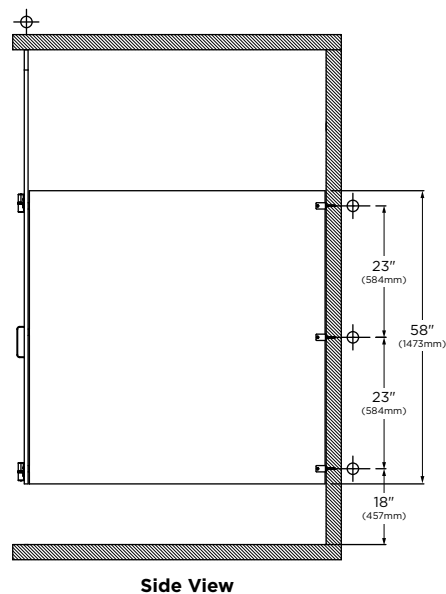
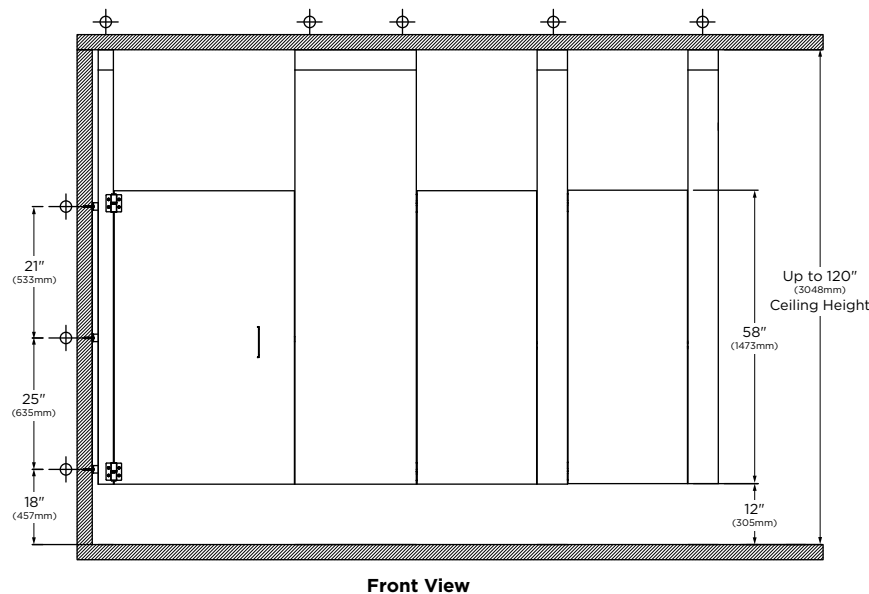

STANDARD:

- ☐ #1048 - Barrel Hinge and Standard Bracket

MODEL OPTIONS:

- ☐ #1048.65 - Continuous Hinge and Continuous Bracket
- ☐ #1048.65D - Continuous Hinge and Standard Bracket
- ☐ #1048.65DDS - Continuous Hinge, Standard Bracket and Door Stop
- ☐ #1048.65DS - Continuous Hinge, Continuous Bracket and Door Stop
- ☐ #1048.65P - Barrel Hinge and Continuous Bracket

CONTINUOUS .65 BRACKET (OPTION):

Mounting brackets are constructed of 18-8, Type-304, heavy-gauge stainless steel with satin finish: one-piece, full-height U-channels and angle brackets are 18 gauge (1.2mm). U-channels secure panels to stiles, and angle brackets secure panels and stiles to walls. Theft-resistant, stainless steel pin-in-head, torx screws are furnished for U-channels, strip bracket and angle brackets.

#1001371 Angle Bracket

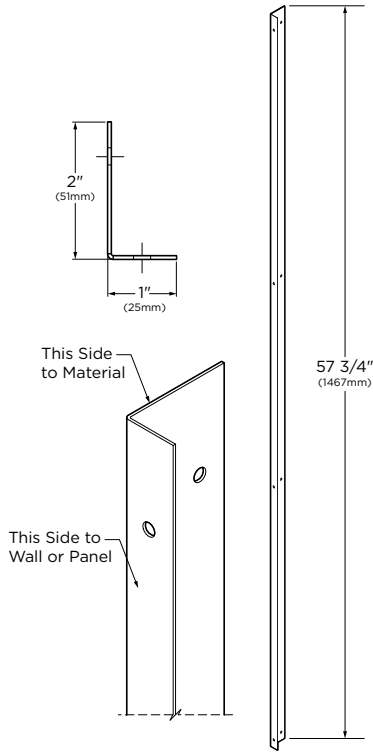

#1001365 U-Channel

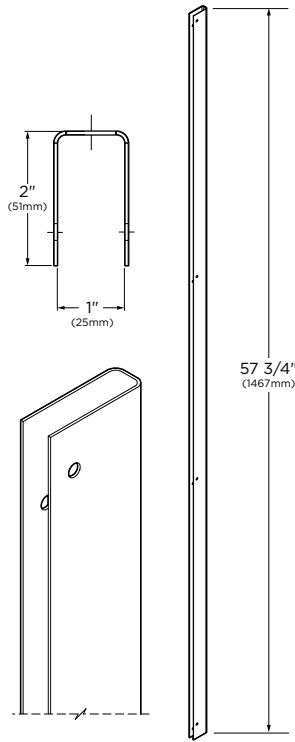

#1001375 Strip Bracket

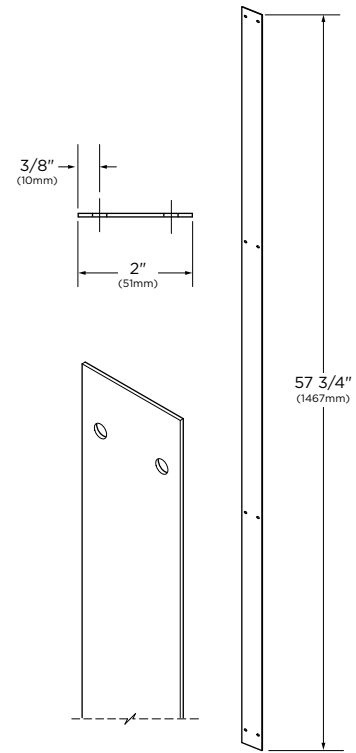

CONTINUOUS .65 HINGES (OPTION):

Hinges are constructed of 18-8, Type-304, heavy-gauge stainless steel with satin finish: one-piece, full-height hinge is 16 gauge (1.6mm); Theft-resistant, stainless steel pin-in-head, torx screws are furnished for door hardware. Doors are equipped with a gravity type self-closing hinge. Threaded inserts are factory installed to secure door hinge. **The continuous hinge (.65 option) depends on the weight of the door to return the hinge to its closed position, which may result in door slamming.**

**#1002920
Left-Hand Inswing or
Right-Hand Outswing**

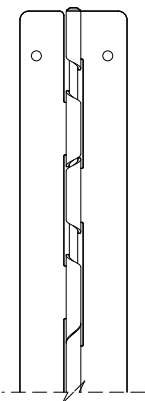
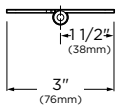

**#1002921
Right-Hand Inswing
or Left-Hand Outswing**

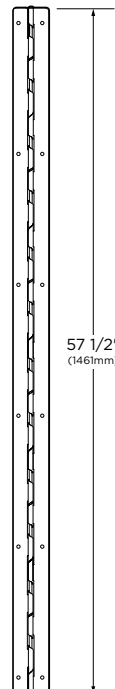
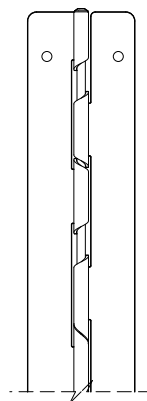
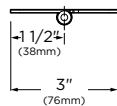

HINGE CAM MAINTENANCE:

Cleaning and lubricating hinge is required to avoid failure of hinge mechanism. Must use a Teflon type based lubricant such as Tri-Flow Superior Lubricant with P.T.F.E. It is not recommended to use machine oil or WD-40 which will collect dust and dirt.

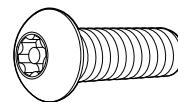

**#1002494
1/4-20 x 3/4"
Pin-in-Head Torx Screw**

☐ **OCCUPANCY INDICATOR LATCH (OPTION):**

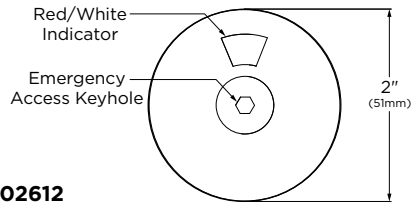

**#1002612
Occupancy Indicator
Latch Packet**

Emergency Access - The latch allows the door to be opened from the exterior of the toilet compartment by inserting a 3mm Allen key into the keyhole in the center of the cover plate and turning the key to release the latch.

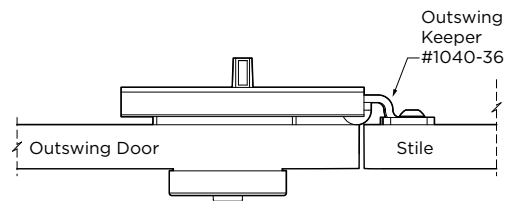
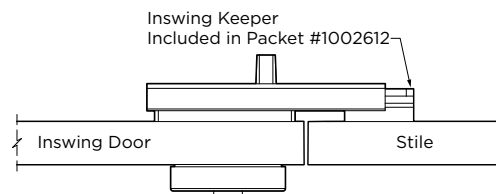

☐ **DOOR STOP (OPTION):**

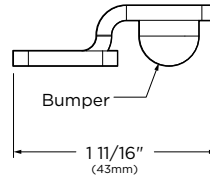

**#1040-110
Door Stop Packet**

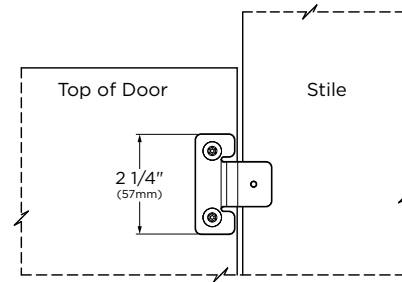
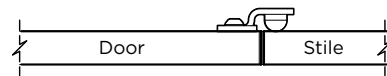
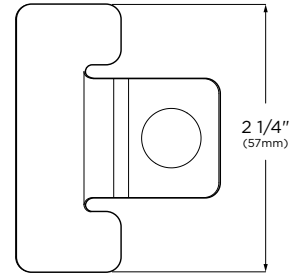

1040 URINAL SCREENS:

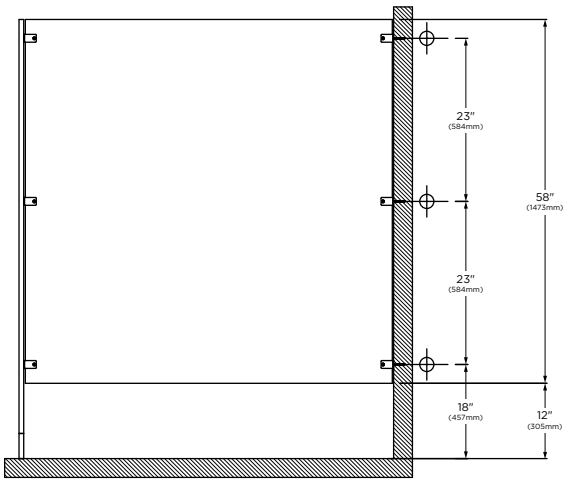

FLOOR ANCHORED URINAL SCREEN

STANDARD:

□ #1041 - Standard Bracket

MODEL OPTIONS:

□ #1041.65 - Continuous Bracket

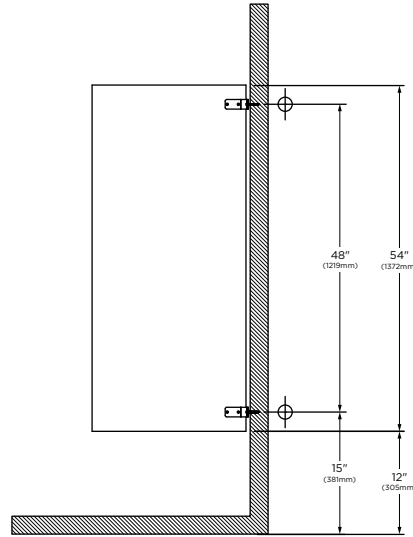

WALL MOUNTED URINAL SCREEN

Up to 54" (1372mm) high.

STANDARD:

□ #1045 - Standard Bracket

MODEL OPTIONS:

□ #1045.65 - Continuous Bracket

#1000357 W/H Urinal Screen Bracket

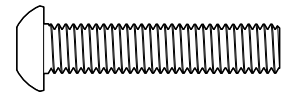
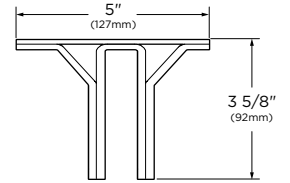
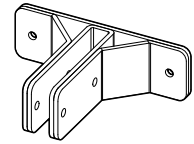

#1000134
#10-32 x 1-3/4" (44mm)
Phillips



#1000133
Acorn Nut #10-32
Through-Bolt
Urinal Screen

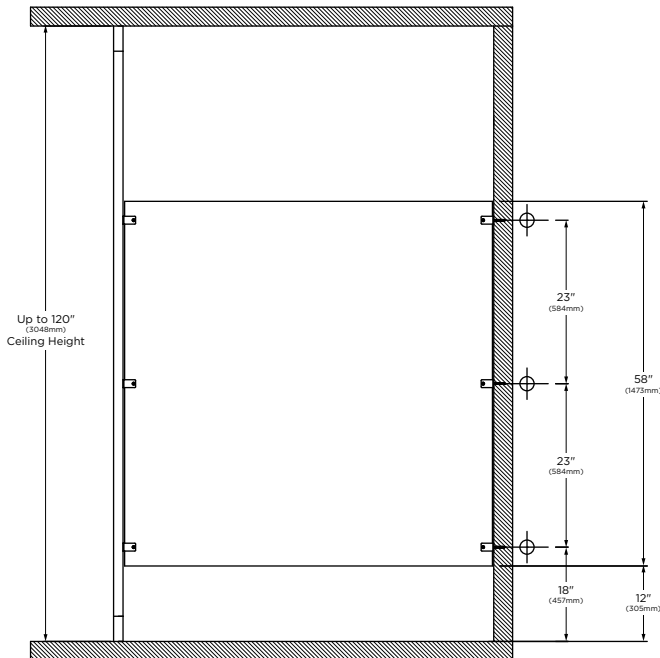

POST-TO-CEILING URINAL SCREEN

STANDARD:

□ #1043 - Standard Bracket

MODEL OPTIONS:

□ #1043.65 - Continuous Bracket

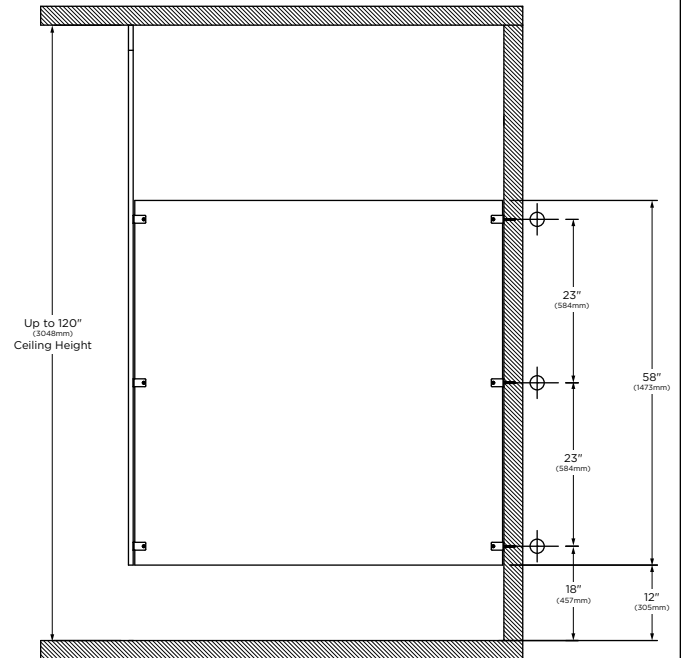

CEILING-HUNG URINAL SCREEN

STANDARD:

□ #1048 - Standard Bracket

MODEL OPTIONS:

□ #1048.65 - Continuous Bracket

INSTALLATION:

Refer to Bobrick installation instructions packed with each shipment. Also available on bobrick.com. Form No. 1040-69.

NOTES:

1. Where water from showers or hose-down cleaning comes in contact with partitions, Bobrick 1080 Series water-resistant, solid phenolic partitions are recommended.
2. Ceiling-hung partitions require structural members (not furnished by Bobrick) in ceiling. For suggested types of ceiling support systems, see Bobrick Advisory Bulletin TB-32.
3. Wall backing is required to secure the mounting brackets of panels, stiles, and wall posts. For suggested wall backing, see Bobrick Advisory Bulletin TB-46.
4. Floor-anchored stiles are furnished with expansion anchors and threaded rods. The expansion anchors require minimum 2" (50mm) penetration into minimum 3" (75mm) thick structural concrete.
5. Bobrick stainless steel partition-mounted washroom accessories are available for mounting in panels between two compartments. See current Bobrick Catalog for description of accessories. Cutouts in panels can be pre-cut for Bobrick models at factory if location and size of all cutouts and Bobrick model numbers are furnished at time of order.
6. When the cam has been set at the desired free resting position, "either closed or open" the top of the affixed components will be aligned.

GUARANTEE:

The Bobrick toilet partition panels, doors and stiles are warranted for a period of 2 years against breakage, corrosion, delaminating and defects in workmanship from the date of purchase for the periods set forth (this limited warranty is conditioned on the toilet partitions being properly installed, used and serviced). Spraying down or hosing HPL partitions voids warranty. Any products returned to Bobrick under this guarantee will be repaired or replaced at no charge.

SPECIFICATION:

High pressure laminate _____ (insert one: toilet partitions, dressing compartments, urinal screens, entrance screens) shall be _____ (insert one: floor-anchored, overhead-braced, ceiling-hung, wall-hung, post-to-ceiling). Stiles, panels and doors shall have a finished thickness of 1" (25mm). Core of panels and doors shall be 3-ply, 45-lb (20.4-kg) density, resin-impregnated particle board. Stiles shall have 3-ply, 45-lb (20.4-kg) density, resin-impregnated particle board bonded to each side of 11-gauge (3.2mm) sheet steel that serves as reinforcing core. Stiles shall have leveling device that is welded to the sheet-steel core and concealed by a one-piece, Type-304, satin-finish stainless steel shoe that is 4" (100mm) high. Surfaces and edges shall be .050" (1.3mm) thick, high-pressure laminate with colored face sheets and matte finish; bonding shall be done using adhesives especially formulated to prevent delamination from moisture and heat normally existing in public washrooms. Stiles, panels and doors shall be _____ (insert color name and number from current Bobrick Catalog). Headrails for overhead-braced compartments shall be anodized aluminum with satin finish. All door hardware and mounting brackets shall be Type-304 stainless steel with satin finish. No door hardware or mounting brackets shall be exposed on exterior of compartments, except on outswing doors. Threaded inserts shall be factory installed for securing hinges on doors and for securing door latches. Theft-resistant, stainless steel pin-in-head, torx screws shall be furnished for door hardware and all mounting brackets. A clothes hook shall be furnished for each door. Hinges shall be adjustable to hold doors of unoccupied compartments partially open or fully closed, and shall allow a locked compartment to be opened from outside by lifting door to disengage latch from keeper.

*To specify continuous hardware, replace end of specifications paragraph with: .65 option All door hardware, U-channels, and angle brackets shall be Type-304 stainless steel with satin finish: one-piece, full-height hinges shall be 16 gauge (1.6mm); one-piece door keepers shall be 11 gauge (3.2mm); one-piece, full-height U-channels and single brackets shall be 18 gauge (1.2mm). U-channels shall be furnished to secure panels to stiles, and angle brackets furnished to secure panels and stiles to walls. Theft-resistant, stainless steel pin-in-head, torx screws shall be furnished for door hardware, U-channels, and angle brackets. Hinges shall allow locked compartment to be opened in emergency from outside by lifting door to disengage latch from keeper. Doors shall be equipped with a self-closing hinge. Threaded inserts shall be factory installed to secure all door hinges and latches.

_____ (insert one: Toilet Partitions, Dressing Compartments, Shower Dividers, Urinal Screens, Entrance Screens) shall be _____ Series (insert series number) of Bobrick Washroom Equipment, Inc., Clifton Park, New York; Jackson, Tennessee; Los Angeles, California; Bobrick Washroom Equipment Company, Scarborough, Ontario; Bobrick Washroom Equipment Pty. Ltd., Australia; and Bobrick Washroom Equipment Limited, United Kingdom.

HEIGHT		COLOR SELECTION	DISTRIBUTOR	35205 - FRY SPECIALTY INC			Note: Dimensions are in inches
PANEL	58	NO COLOR 1 RR	QUOTE#/S.O.#	9008365-1			
STILE	83	NO COLOR 1 RR	P.O.#	JOB NAME	MANSIONS AT MARINE CREEK		
DOOR	58	NO COLOR 1 RR	DATE	3/17/2024	ROOM	Mens	

Toilet partition and urinal screen layout drawings are the sole, confidential and proprietary property of Bobrick Washroom Equipment, Inc. The layout drawings are custom designed and prepared exclusively for the quotation and manufacture of Bobrick toilet partitions and urinal screens for the distributor and job name stated on the layout. Reproduction or distribution of the layout drawings to other toilet partition manufacturers or other persons without the prior written permission of Bobrick Washroom Equipment is strictly prohibited.



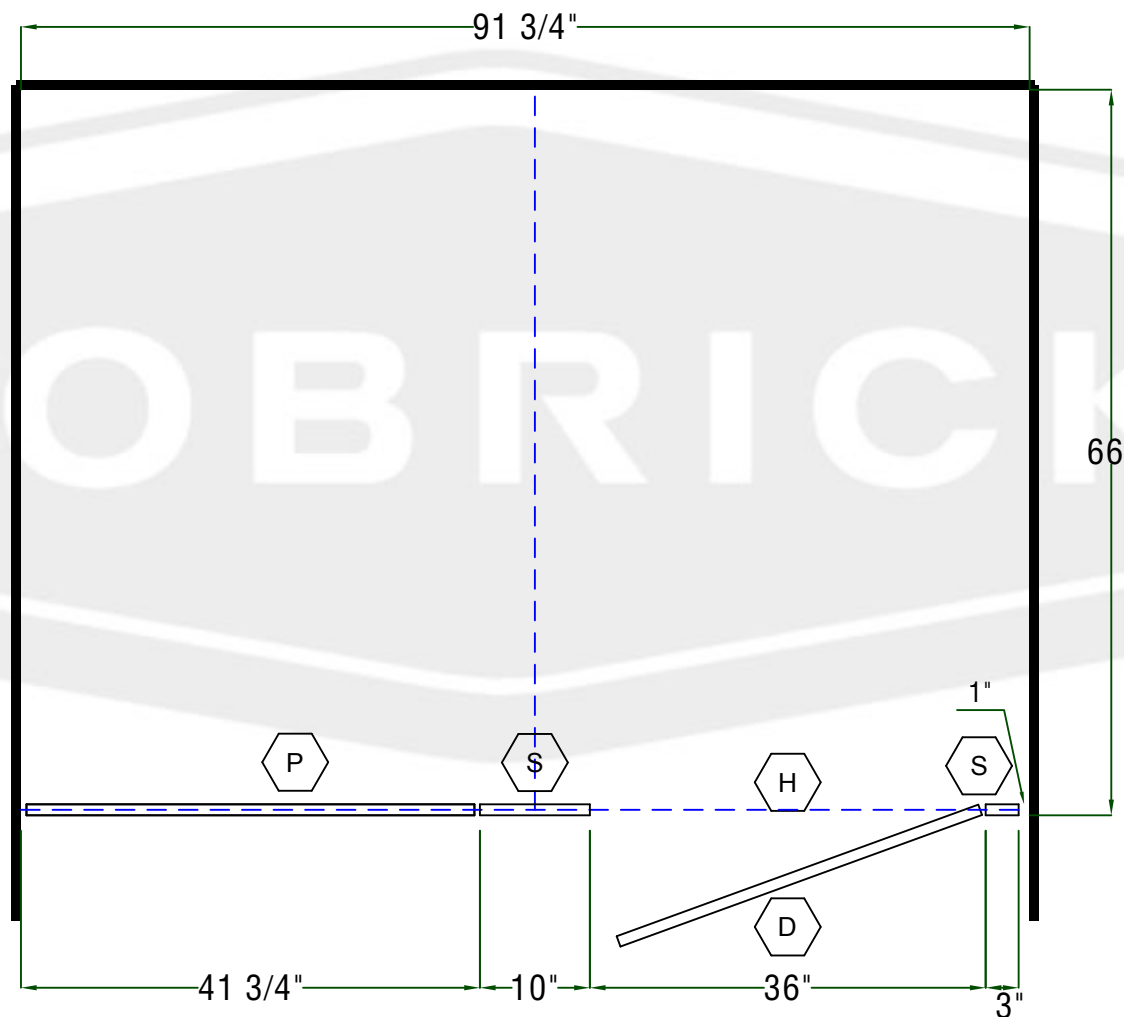



FLOOR CLEARANCE 12



MAKE 1 UNITS THUS

EACH DRAWING MUST BE SIGNED APPROVED BEFORE FABRICATION CAN BEGIN. FABRICATION WILL BE FROM FINAL APPROVED DRAWINGS ONLY. PLEASE REVIEW CAREFULLY BEFORE SIGNING APPROVED.

1. O.A.=OVERALL GAP, 1/2" FROM WALL TO PANEL
PLUS 1/4" PANEL TO STILE
NOTES FOR INSTALLER: UNLESS OTHERWISE SPECIFIED

 STILE  WALLPOST  DOOR  PANEL  HEADRAIL  BENCH

APPROVED

<div>BOBRICK</div> <div>DESIGNER</div>		Series: 1045	Type: Screen Wall Hung	Layout: Urinal Screen	2 Of 3
COLOR SELECTION NO COLOR 1 RR NO COLOR 1 RR NO COLOR 1 RR		DISTRIBUTOR 35205 - FRY SPECIALTY INC QUOTE#/S.O.# 9008365-1 P.O.# DATE 3/17/2024		Note: Dimensions are in inches JOB NAME MANSIONS AT MARINE CREEK ROOM N/A	
<p>Toilet partition and urinal screen layout drawings are the sole, confidential and proprietary property of Bobrick Washroom Equipment, Inc. The layout drawings are custom designed and prepared exclusively for the quotation and manufacture of Bobrick toilet partitions and urinal screens for the distributor and job name stated on the layout. Reproduction or distribution of the layout drawings to other toilet partition manufacturers or other persons without the prior written permission of Bobrick Washroom Equipment is strictly prohibited.</p> <p>FLOOR CLEARANCE 18</p> <div><div><p>PLAN VIEW</p></div><div><p>SIDE VIEW</p></div></div> <div><div>MAKE 1 UNITS THUS</div><div><div>1. O.A.=OVERALL GAP, 1/2" FROM WALL TO PANEL PLUS 1/4" PANEL TO STILE NOTES FOR INSTALLER: UNLESS OTHERWISE SPECIFIED</div><div><div>S</div> STILE <div>W</div> WALLPOST <div>D</div> DOOR <div>P</div> PANEL <div>H</div> HEADRAIL <div>B</div> BENCH</div></div><div><div>EACH DRAWING MUST BE SIGNED APPROVED BEFORE FABRICATION CAN BEGIN. FABRICATION WILL BE FROM FINAL APPROVED DRAWINGS ONLY. PLEASE REVIEW CAREFULLY BEFORE SIGNING APPROVED.</div><div>APPROVED _____</div></div></div>					

HEIGHT		COLOR SELECTION	DISTRIBUTOR	35205 - FRY SPECIALTY INC	Note: Dimensions are in inches	
PANEL	58	NO COLOR 1 RR	QUOTE#/S.O.#	9008365-1		
STILE	83	NO COLOR 1 RR	P.O.#			
DOOR	58	NO COLOR 1 RR	DATE	3/17/2024		
			JOB NAME	MANSIONS AT MARINE CREEK		
			ROOM	Womens		

Toilet partition and urinal screen layout drawings are the sole, confidential and proprietary property of Bobrick Washroom Equipment, Inc. The layout drawings are custom designed and prepared exclusively for the quotation and manufacture of Bobrick toilet partitions and urinal screens for the distributor and job name stated on the layout. Reproduction or distribution of the layout drawings to other toilet partition manufacturers or other persons without the prior written permission of Bobrick Washroom Equipment is strictly prohibited.

FLOOR CLEARANCE 12

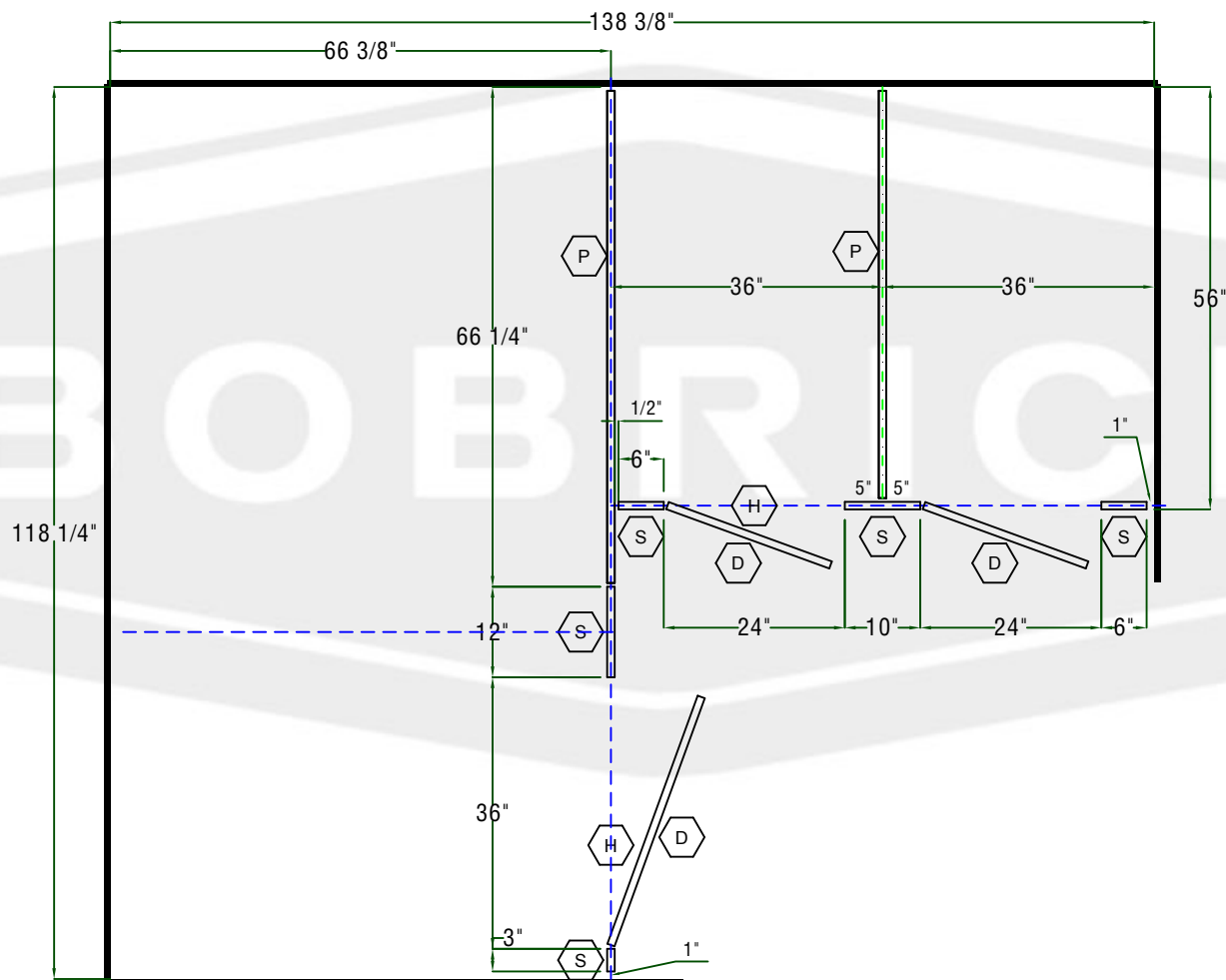

MAKE 1 UNITS THUS

1. O.A.=OVERALL GAP, 1/2" FROM WALL TO PANEL
PLUS 1/4" PANEL TO STILE
NOTES FOR INSTALLER: UNLESS OTHERWISE SPECIFIED

(S) STILE (W) WALLPOST (D) DOOR (P) PANEL (H) HEADRAIL (B) BENCH

EACH DRAWING MUST BE SIGNED APPROVED BEFORE FABRICATION CAN
BEGIN. FABRICATION WILL BE FROM FINAL APPROVED DRAWINGS ONLY.
PLEASE REVIEW CAREFULLY BEFORE SIGNING APPROVED.

APPROVED _____



HIGH PRESSURE LAMINATE (HPL) STANDARD COLORS & PATTERNS

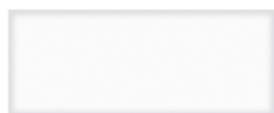

Designer White
D354-60

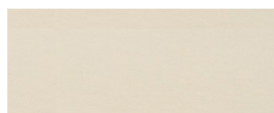

Natural Almond
D30-60



Beige
1530-60



Otter
3202-58



Shadow
D96-60



Slate Grey
D91-60

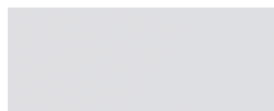

Moonstone
7872-58



Grey
1500-60



Platinum
D315-60



Mouse
928-58



Terril
2297-58



Black
1595-60



White Carrara
4924-38



Neutral Weft
5875-58



Flax Gauze
7708-58



Desert Zephyr
4841-60



Cardboard Solidz
7813-58



Pewter Mesh
4878-38



Sheer Mesh
4876-38



Classic Linen
4943-38

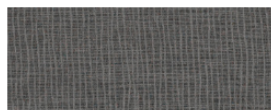

Citadel Warp
5882-58



Silver Galaxy Slate
9528-58



White Ash
8841-58



Danish Maple
8906-58



Millennium Oak
5887-58



Bleached Legno
8845-58



Smoky Brown Pear
5488-58



Blackened Steel
8918-58