



Estimate

ADDRESS
CREATIVE QUALITY CONSTRUCTION
ATTN: MIKE DUNHAM

ESTIMATE 11322
DATE 04/17/2024

SALES REP
CHRISTINA 619-635-2888

ACTIVITY	DESCRIPTION	QTY
MATERIAL-EXPENSE	PLASTIC LAMINATE BY BOBRICK PER ATTACHED	
STYLE	FLOOR MOUNTED/OVERHEAD BRACED	
HARDWARE	HARDWARE INCLUDED PER ATTACHED	
COLOR	STANDARD COLOR INCLUDED	
STALLS	INCLUDED IN PROPOSAL	15
URINAL SCREEN	INCLUDED IN PROPOSAL	6
CAN SHIP IN	APPROX. 2 WEEKS	
STANDARD FREIGHT INCLUDED	BASED ON (1) SINGLE SHIPMENT TO 75119	

*** SALES TAX WILL BE ADDED IF SHIPPING TO CA, TN, TX, OK, NY, FL, GA, MA, NJ, WA, AZ, MI, MN, NC, VA, IL AND MD.

• QUOTES ARE VALID FOR 30 DAYS
• QUANTITIES & DESCRIPTIONS NOT GUARANTEED TO AGREE WITH PLANS AND/OR SPECS. IT IS YOUR RESPONSIBILITY TO REVIEW ENTIRE QUOTE/SUBMITTAL PRIOR TO BIDDING YOUR PROJECT. YOU ARE ALSO RESPONSIBLE FOR VERIFYING LOCAL MUNICIPALITY / CODE COMPLIANCE.
ANY CHANGES MADE CAN IMPACT PRICING.

TOTAL

\$9,155.00

Accepted By

Accepted Date

Shipping Information (PLEASE MARK ALL THAT APPLY):

- 
- ☐ Ship ASAP
 - ☐ Do NOT Ship Before Date ____/____/____
 - ☐ Lift Gate Fee Add. \$125.00
 - ☐ **(REQUIRED IF NO FORKLIFT OR LOADING DOCK)**
 - ☐ Residential / Non-Commercial Delivery Add. \$95.00*
 - ☐ Notification call prior to delivery Add \$40.00

APPROVED: _____

*** The term "residential/non-commercial" also includes apartments, places of worship, schools, pre-schools, day cares, camps, farms, public storage facilities, business operating within a private residence, and other such locations not generally recognized as commercial locations and shall apply to the entire premises.**



Technical Data

MetroSeries™

High Pressure Laminate Partitions and Screens

1550 SERIES

SPECIFICATION

Height: 58" (1473mm) Doors and Panels with 12" (305mm) Floor Clearance

MATERIAL

Stiles* — 1" (25mm) finished thickness: 3-ply, 45-lb (20.4-kg) density, resin-impregnated particle board; surfaces and edges are .050" (1.3mm) thick, high-pressure plastic laminate with colored face sheets and matte finish.

Standard Size Stiles:

- For compartments — 3", 4", 5", 6", 7", 8", 10", 12", 16", 18", 20", or 24" (76, 102, 127, 152, 179, 203, 254, 305, 406, 457, 508, 610mm) wide.
- For screens — 6" (152mm) wide.
- Floor-anchored — 69" (1753mm) high.
- Overhead-braced — 83" (2108mm) high.
- Ceiling-hung — 83" (2108mm) high for 96" (2438mm) ceilings or as required up to 120" (3048mm) ceilings.

Panels — 1" (25mm) finished thickness: 3-ply, 45-lb (20.4-kg) density, resin-impregnated particle board; surfaces and edges are .050" (1.3mm) thick, high-pressure plastic laminate with colored face sheets and matte finish.

Standard Size Panels:

- For compartments — Up to 84" (2134mm) wide; 58" (1473mm) high.

Urinal Screens — 1" (25mm) finished thickness: 3-ply, 45-lb (20.4-kg) density, resin-impregnated particle board; surfaces and edges are .050" (1.3mm) thick, high-pressure plastic laminate with colored face sheets and matte finish.

Standard Size Urinal Screens:

- For wall-hung screens — Up to 24" (610mm) wide; 42" to 54" (1067 to 1372mm) high.
- For ceiling-hung and floor anchored screens — Up to 60" (1524mm) wide; 58" (1473mm) high.

Doors — 1" (25mm) finished thickness: 3-ply, 45-lb (20.4-kg) density, resin-impregnated particle board; surfaces and edges are .050" (1.3mm) thick, high-pressure plastic laminate with colored face sheets and matte finish.

Standard Size Doors:

- Inswing and outswing doors are standard 22" to 37" (559 to 940mm) wide; 58" (1473mm) high.

Headrail (1552 Series Only) — Extruded anodized aluminum. Enclosed construction with vandal-resistant sloping top.

Shoe — 18-8, Type-304, 22-gauge (0.8mm) stainless steel with satin finish; 4" (102mm) high.

Wall Posts — 1" by 1 1/2" (25 by 38mm) wide tubing; 18-8, Type-304, 16-gauge (1.6mm) stainless steel with satin-finish. 58" (1473mm) high, pre-drilled for door hardware.

TOP VIEW OF 1552 (BARREL HINGE AND STANDARD BRACKET) INSTALLATION.

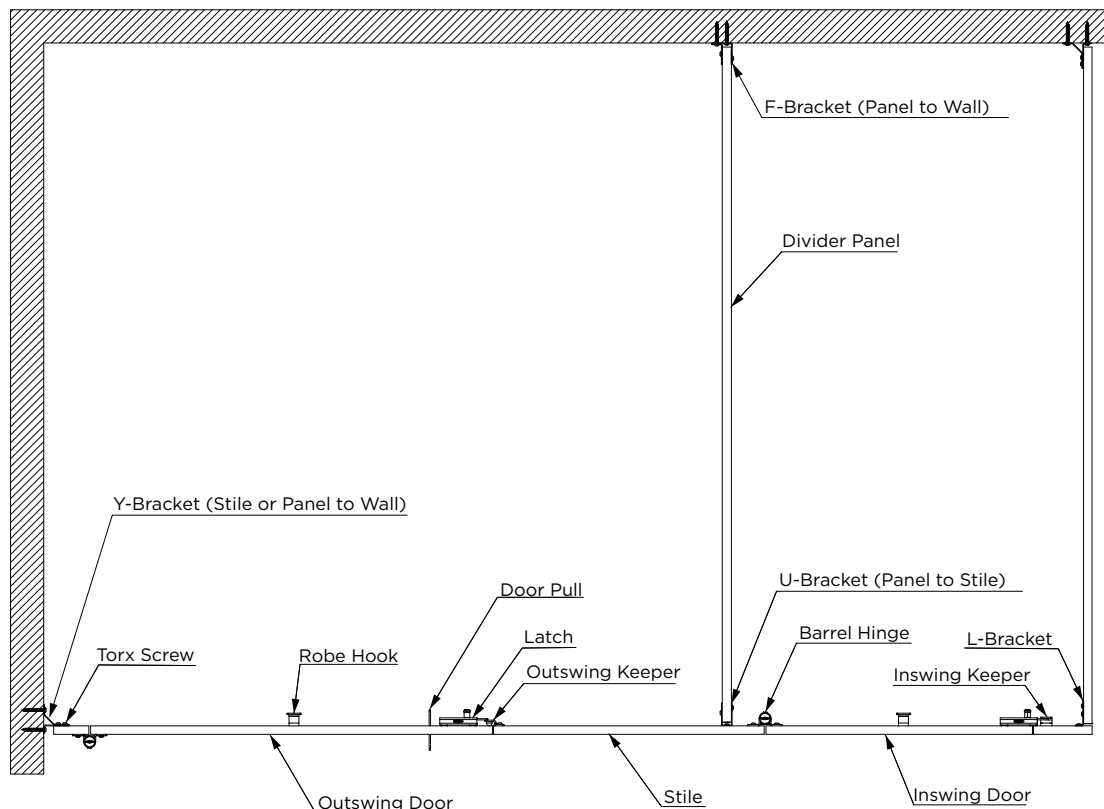

ANCHORING DEVICE:

Leveling Device — Floor-Anchored or Ceiling-Hung: 3/8" x 1" (10 x 25mm) steel bar, zinc-chromate plated, bolted to stile using 6" x 3/8" (152 x 10mm) diameter carbon steel lag bolt. Furnished with 3/8" (10mm) diameter threaded rods, hex nuts, washers, spacer sleeve(ceiling-hung only), expansion shield and shoe retainer.

Floor-Anchored Leveling Device Detail

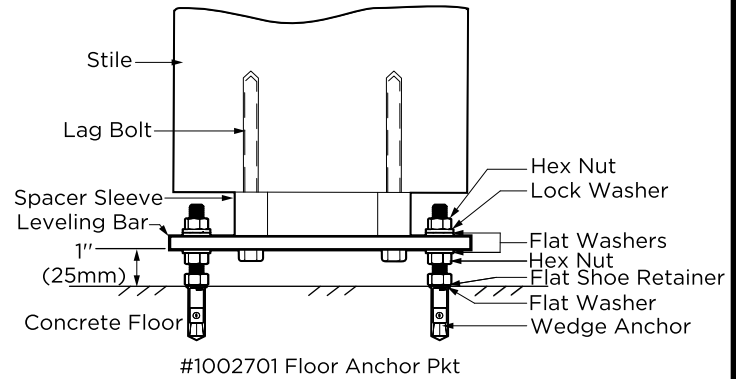

CEILING LEVELING DEVICE

Provisions must be in the construction of the building to support ceiling-hung toilet partitions. Structure in ceiling, not furnished by Bobrick, must support at least 295 lb per high pressure laminate toilet compartment, and must be sufficiently rigid to withstand swinging motion of toilet partition doors and impact of doors against stiles. Actual mounting system, including lateral bracing, if required, must be designed by the architect or structural engineer, and furnished by others. Wood beams are not recommended for ceiling hung application.

Note: If adequate ceiling support cannot be provided, the floor anchored or overhead-braced toilet compartments are recommended.

Approximate Weight: High Pressure Laminate Toilet Compartment - 295lbs.

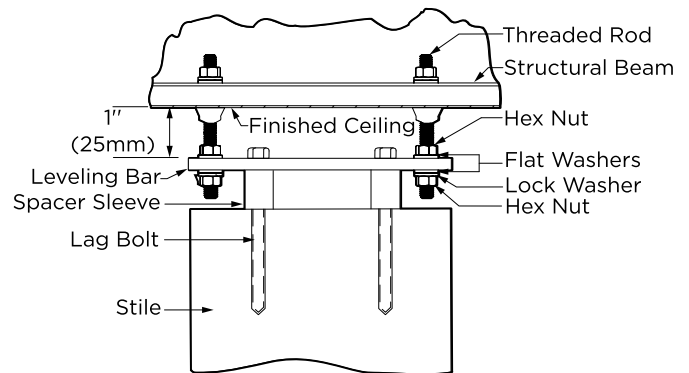

OVERHEAD-BRACED LEVELING DEVICE

Leveling Device — Overhead-Braced Series: 12-gauge (2.8mm), 3" x 1 1/4" (75 x 32mm) plated steel stile bracket factory installed to bottom of stile. Furnished with leveling bolt, shoe retainer, floor L-bracket, plastic anchor #14-16, #14 x 5/8" (M6.3 x 16mm) stainless steel sheet-metal screws and #14 x 1 3/4" (M6.3 x 45mm) stainless steel sheet-metal floor screws.

Overhead-Bracing Detail

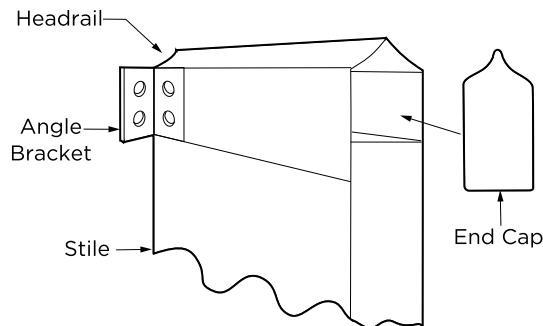

Overhead-Braced Floor Leveling Device

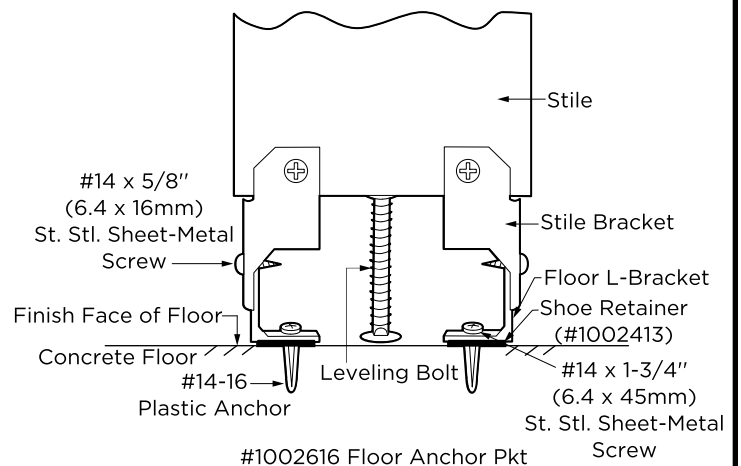

COMMERCIAL HARDWARE (STANDARD)

Hinges, door latch, door keepers, clothes hooks, mounting brackets and door handles are constructed of 18-8, Type-304, heavy-gauge stainless steel with satin finish.

Threaded inserts are factory installed for securing hinges. Theft-resistant, stainless steel pin-in-head, torx screws are furnished for door hardware and all mounting brackets.

Balanced hinge is adjustable to hold door of unoccupied toilet compartment partially open or fully closed.

Toilet compartment door is locked from inside by sliding door latch into keeper. A locked compartment may be opened from outside by lifting door to disengage latch from keeper. Track of door latch prevents inswing door from swinging out beyond stile; on outswing door, the door keeper prevents it from swinging in beyond stile. Door handles and latch have operable parts that are operable with one hand and do not require tight grasping, pinching, or twisting of the wrist; and comply with ADA Sections 404.2.7 and 309.4. The force required to activate the operable parts shall be 5 pounds (22.2N) maximum. Black rubber bumper on the latch serves as door bumper for inswing door.

#1040-42 LATCH ASSEMBLY

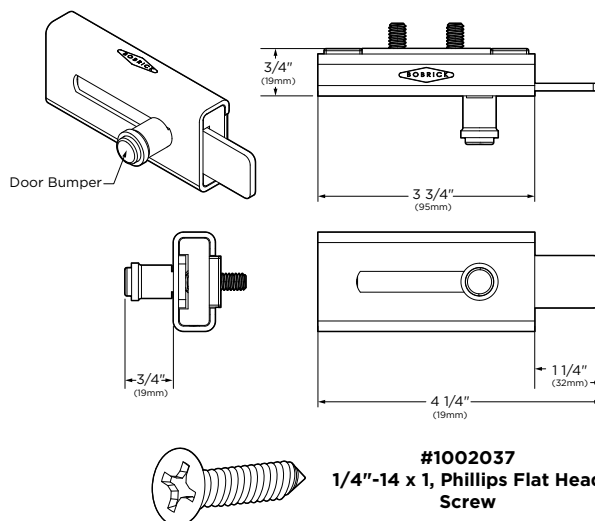

1040-35 KEEPER, INSWING

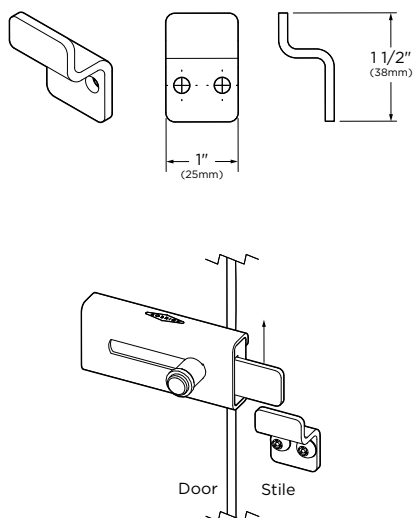

1040-36 KEEPER, OUTSWING

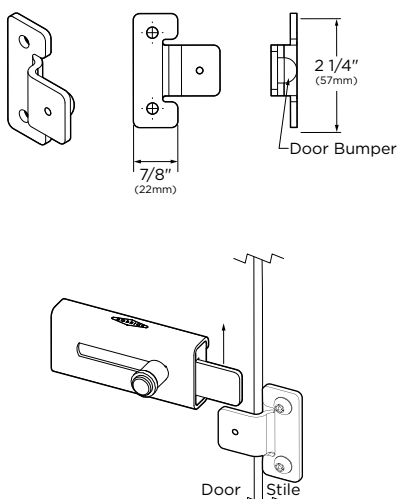

1040-39 PERPENDICULAR

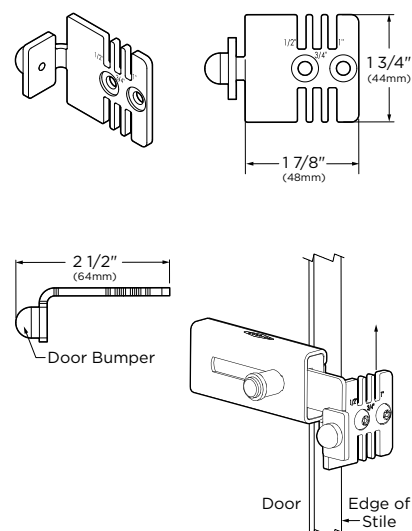

#1040-56 WALL MOUNTED KEEPER INSWING

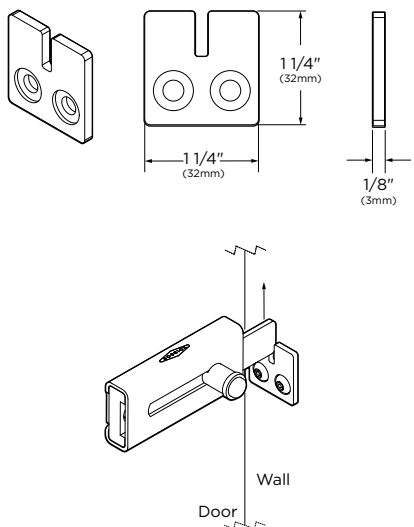

#1000869 COAT HOOK

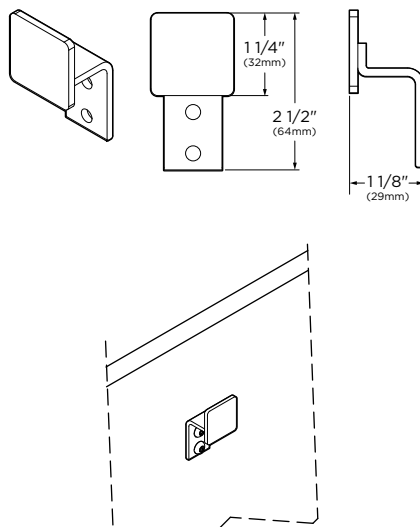

#1000312 DOOR PULL HANDLE

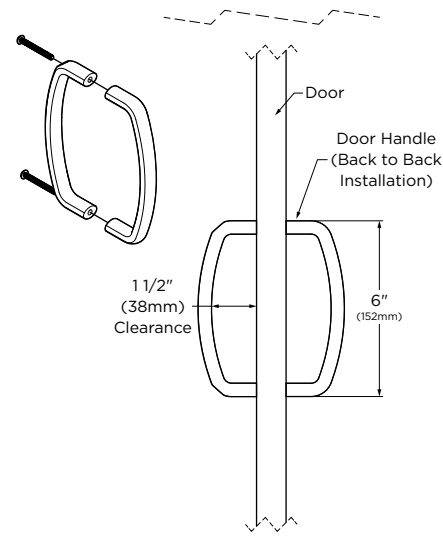

**#1002330
BARREL HINGE SET, L**

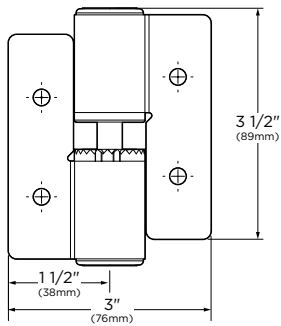

**#1002331
BARREL HINGE SET, J**

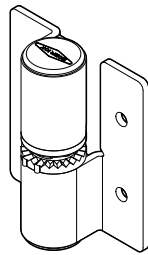
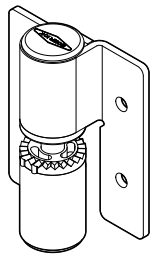
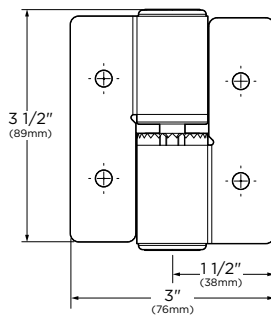

**#1002156
Hinge Cam**



Hinges are constructed of 18-8, Type-304, heavy-gauge stainless steel with satin finish. Threaded inserts are factory installed for securing hinges. Theft-resistant, stainless steel pin-in-head, torx screws are furnished for door hardware. Balanced hinge is adjustable to hold door of unoccupied toilet compartment partially open or fully closed.

CAM SETTINGS

**Door Beyond
Closed Position**

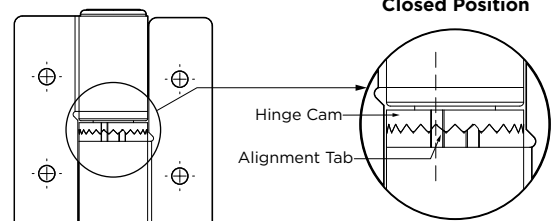

**Door Normal
Closed Position**

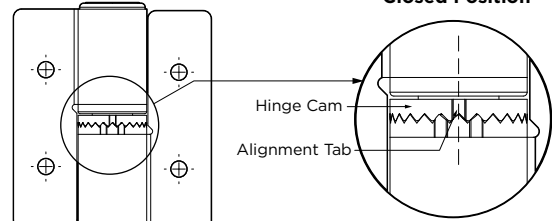

**Door Remain Open
15 Degrees**

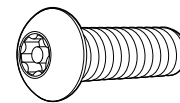
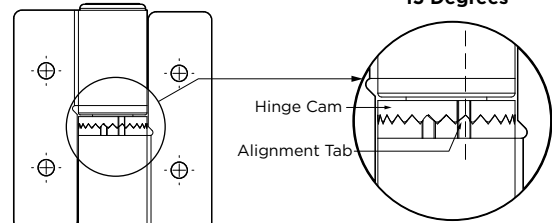

**#1002494
1/4-20 x 3/4"
Pin-in-Head Torx Screw**

BRACKETS (STANDARD):

**#1000351
L-Bracket
(Panel to Corner Stile)**

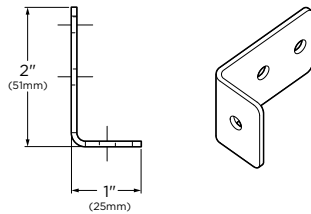

**#1000356
U-Bracket
(Panel to Perp. Stile)**

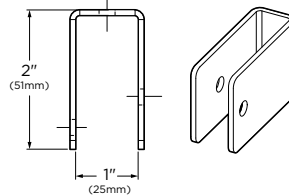

**#1002500
#12 x 3/4" Pin-in-Head Torx Screw
Panel/Stile Screw**

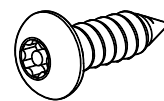

**#1000974
Y-Bracket
(Stile to Wall)**

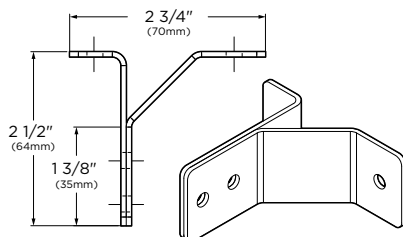

**#1000353
F-Bracket
(Panel to Wall)**

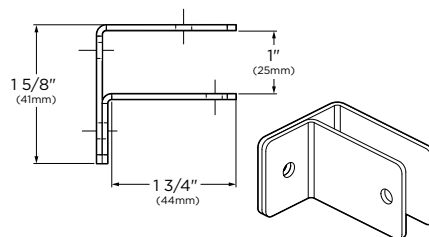

**#1002495
#12 x 2" Pin-in-Head Torx Screw
(M5.5 x 50mm) Wall Screw**

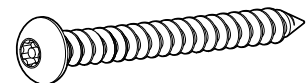

1551 SERIES FLOOR ANCHORED

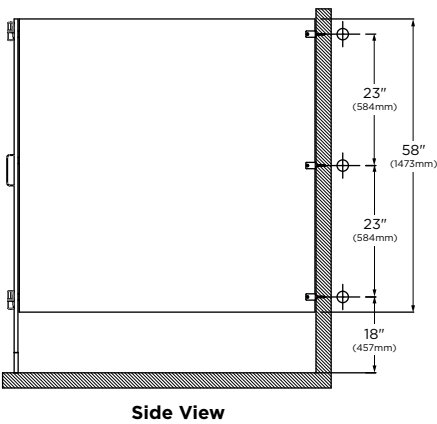
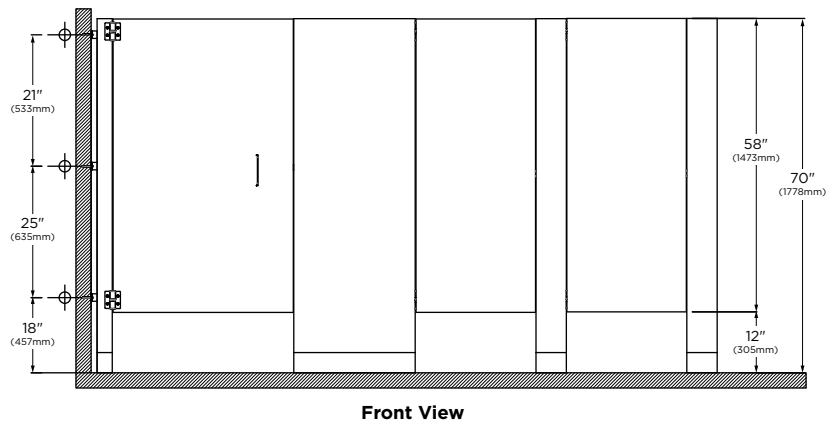

STANDARD:

- #1551 - Barrel Hinge and Standard Bracket

1552 SERIES OVERHEAD-BRACED

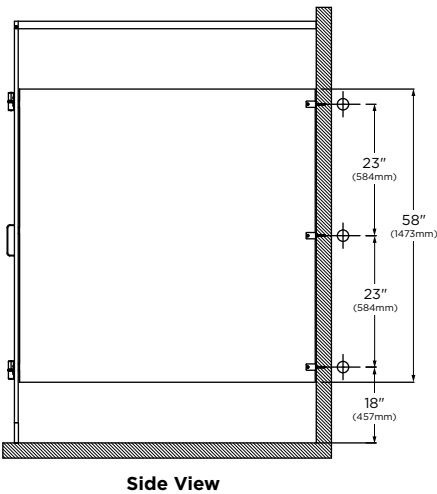
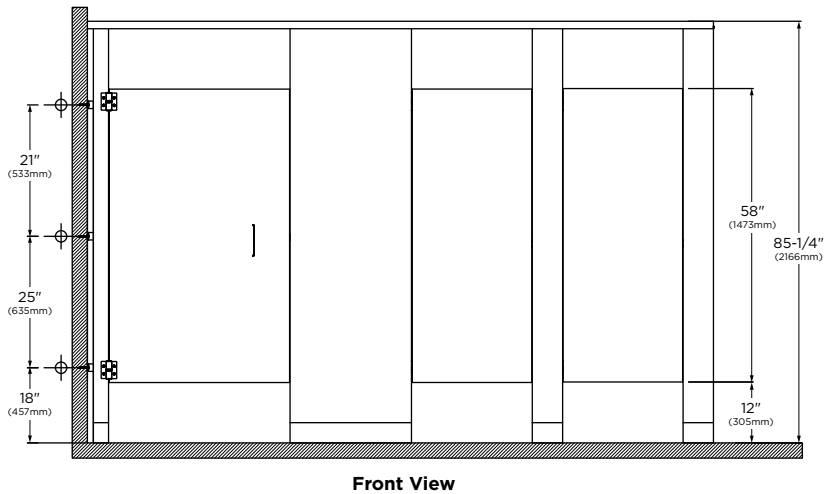

STANDARD:

- #1552 - Barrel Hinge and Standard Bracket

1558 SERIES CEILING HUNG

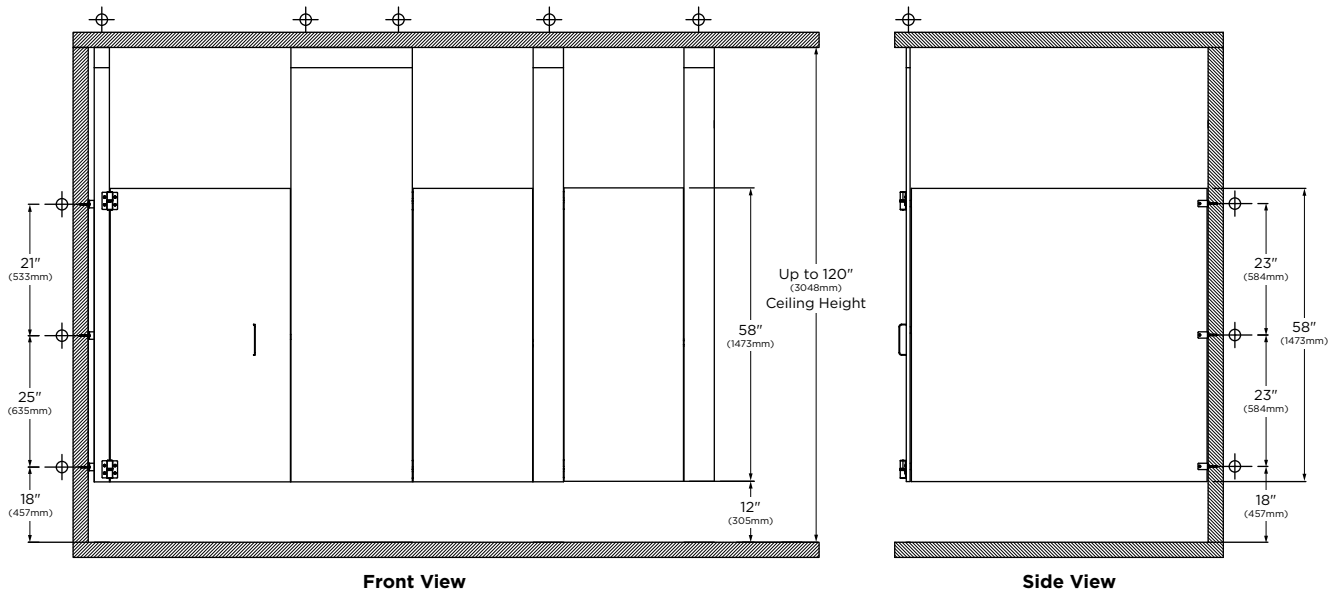

STANDARD:

- #1558 - Barrel Hinge and Standard Bracket

☐ OCCUPANCY INDICATOR LATCH (OPTION):

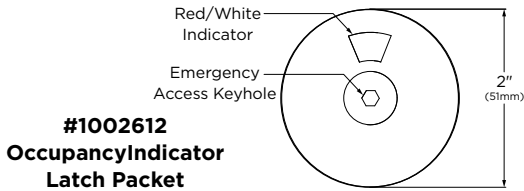

Emergency Access - The latch allows the door to be opened from the exterior of the toilet compartment by inserting a 3mm Allen key into the keyhole in the center of the cover plate and turning the key to release the latch.

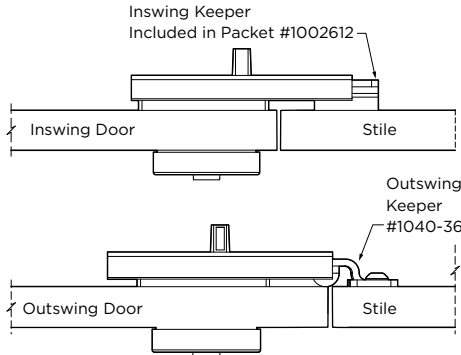

☐ DOOR STOP (OPTION):

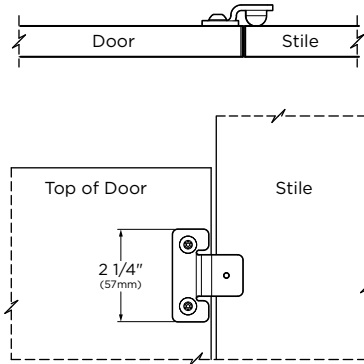
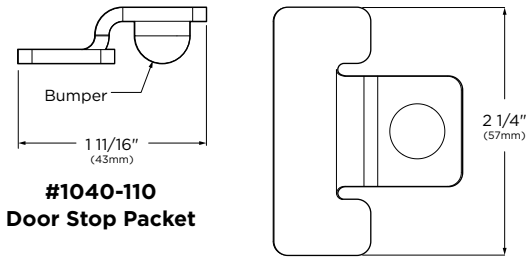

1550 URINAL SCREENS:

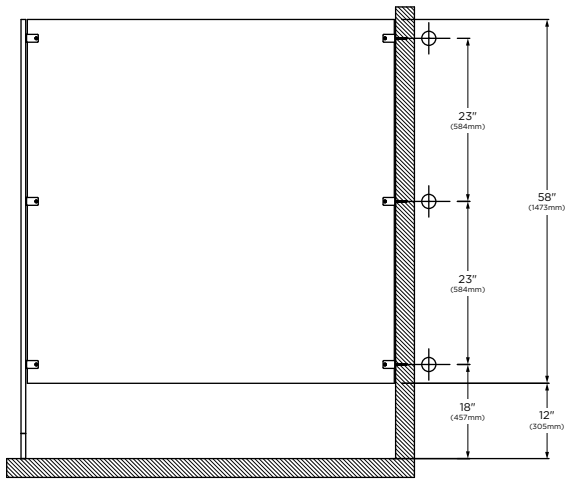

FLOOR ANCHORED URINAL SCREEN

STANDARD:

- #1551 - Standard Bracket

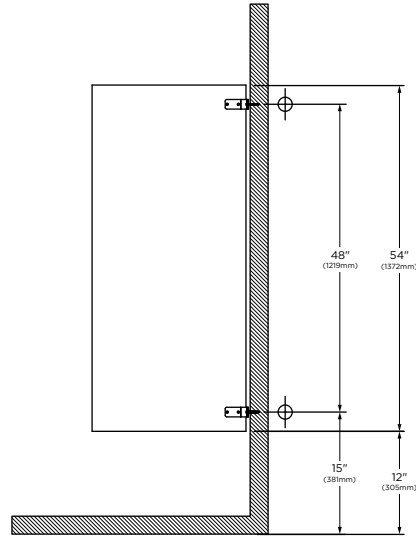

WALL MOUNTED URINAL SCREEN

Up to 54" (1372mm) high.

STANDARD:

- #1555 - Standard Bracket

**#1000357
W/H Urinal Screen Bracket**

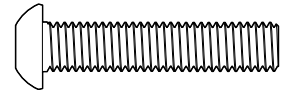
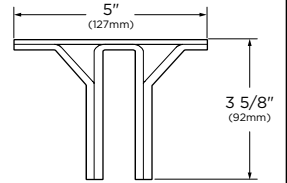
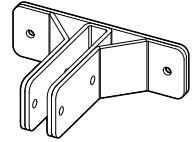

**#1000134
#10-32 x 1-3/4" (44mm)
Phillips**



**#1000133
Acorn Nut #10-32
Through-Bolt
Urinal Screen**

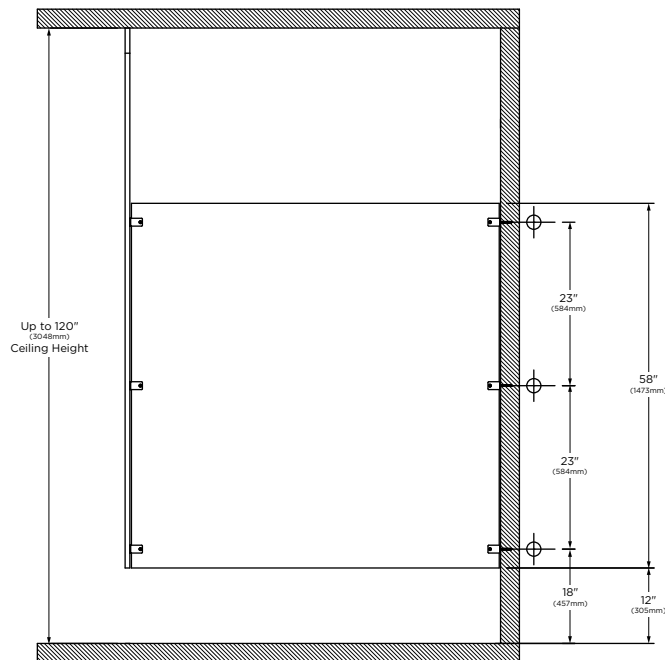

CEILING-HUNG URINAL SCREEN

STANDARD:

- #1558 - Standard Bracket

INSTALLATION:

Refer to Bobrick installation instructions packed with each shipment. Also available on bobrick.com. Form No. 1550-69.

NOTES:

1. Where water from showers or hose-down cleaning comes in contact with partitions, Bobrick 1080 Series water-resistant, solid phenolic partitions are recommended.
2. Ceiling-hung partitions require structural members (not furnished by Bobrick) in ceiling. For suggested types of ceiling support systems, see Bobrick Advisory Bulletin TB-32.
3. Wall backing is required to secure the mounting brackets of panels, stiles, and wall posts. For suggested wall backing, see Bobrick Advisory Bulletin TB-46.
4. Floor-anchored stiles are furnished with expansion anchors and threaded rods. The expansion anchors require minimum 2" (50mm) penetration into minimum 3" (75mm) thick structural concrete.
5. Bobrick stainless steel partition-mounted washroom accessories are available for mounting in panels between two compartments. See current Bobrick Catalog for description of accessories. Cutouts in panels can be pre-cut for Bobrick models at factory if location and size of all cutouts and Bobrick model numbers are furnished at time of order.
6. When the cam has been set at the desired free resting position, "either closed or open" the top of the affixed components will be aligned.

GUARANTEE:

The Bobrick toilet partition panels, doors and stiles are warranted for a period of 2 years against breakage, corrosion, delaminating and defects in workmanship from the date of purchase for the periods set forth (this limited warranty is conditioned on the toilet partitions being properly installed, used and serviced). Spraying down or hosing HPL partitions voids warranty. Any products returned to Bobrick under this guarantee will be repaired or replaced at no charge.

SPECIFICATION:

High pressure laminate (HPL) _____ (insert one product application: toilet partition, dressing compartment or urinal screen) shall be _____ (insert one series: floor-anchored, overhead-braced, wall-hung urinal screens or ceiling-hung). Stiles, panels, and doors shall have a finished thickness of 1" (25mm). Core of panels, doors, and stiles shall be 3-ply, 45-lb (20.4-kg) density, resin-impregnated particle board. Stiles shall have a one-piece, Type-304, satin-finish stainless steel shoe that is 4" (102mm) high. Surfaces and edges shall be .050" (1.3mm) thick, high-pressure laminate with colored face sheets and matte finish; 1 bonding shall be done using adhesives especially formulated to prevent delamination from moisture and heat normally existing in public washrooms. Stiles, panels, and doors shall be _____ (insert color name and number from current Bobrick Toilet Partition Catalog). Headrails for overhead-braced compartments shall be anodized aluminum with satin finish. Hinges, slide latch, door keeper and coat hook shall be stainless steel with satin finish. Stainless steel screws are furnished for all inswing and outswing doors. Mounting brackets shall be 18-8, Type-304, heavy-gauge stainless steel with satin finish. Stainless steel screws shall be furnished for all mounting brackets. Hinges shall be adjustable to hold doors of unoccupied compartments partially open or fully closed, and shall allow a locked compartment to be opened from outside by lifting door to disengage latch from keeper. Screws shall be furnished for all door hardware. Plated-steel Phillips screws shall be furnished for securing door latches.

1Non-standard colors may utilize .035" to 0.39" thick, high pressure laminate.

_____ (insert one: Toilet Partitions, Dressing Compartments, Shower Dividers, Urinal Screens, Entrance Screens) shall be _____ Series (insert series number) of Bobrick Washroom Equipment, Inc., Clifton Park, New York; Jackson, Tennessee; Los Angeles, California; Bobrick Washroom Equipment Company, Scarborough, Ontario; Bobrick Washroom Equipment Pty. Ltd., Australia; and Bobrick Washroom Equipment Limited, United Kingdom.

HEIGHT	COLOR SELECTION
PANEL 58	NO COLOR 1 RR
STILE 83 5/8	NO COLOR 1 RR
DOOR 58	NO COLOR 1 RR

DISTRIBUTOR 35205 - FRY SPECIALTY INC
QUOTE#/S.O.# 9049464-1
P.O.#
DATE 4/18/2024

JOB NAME Creative Quality Const.
ROOM Women 162

Note: Dimensions are in inches

Toilet partition and urinal screen layout drawings are the sole, confidential and proprietary property of Bobrick Washroom Equipment, Inc. The layout drawings are custom designed and prepared exclusively for the quotation and manufacture of Bobrick toilet partitions and urinal screens for the distributor and job name stated on the layout. Reproduction or distribution of the layout drawings to other toilet partition manufacturers or other persons without the prior written permission of Bobrick Washroom Equipment is strictly prohibited.

FLOOR CLEARANCE 12

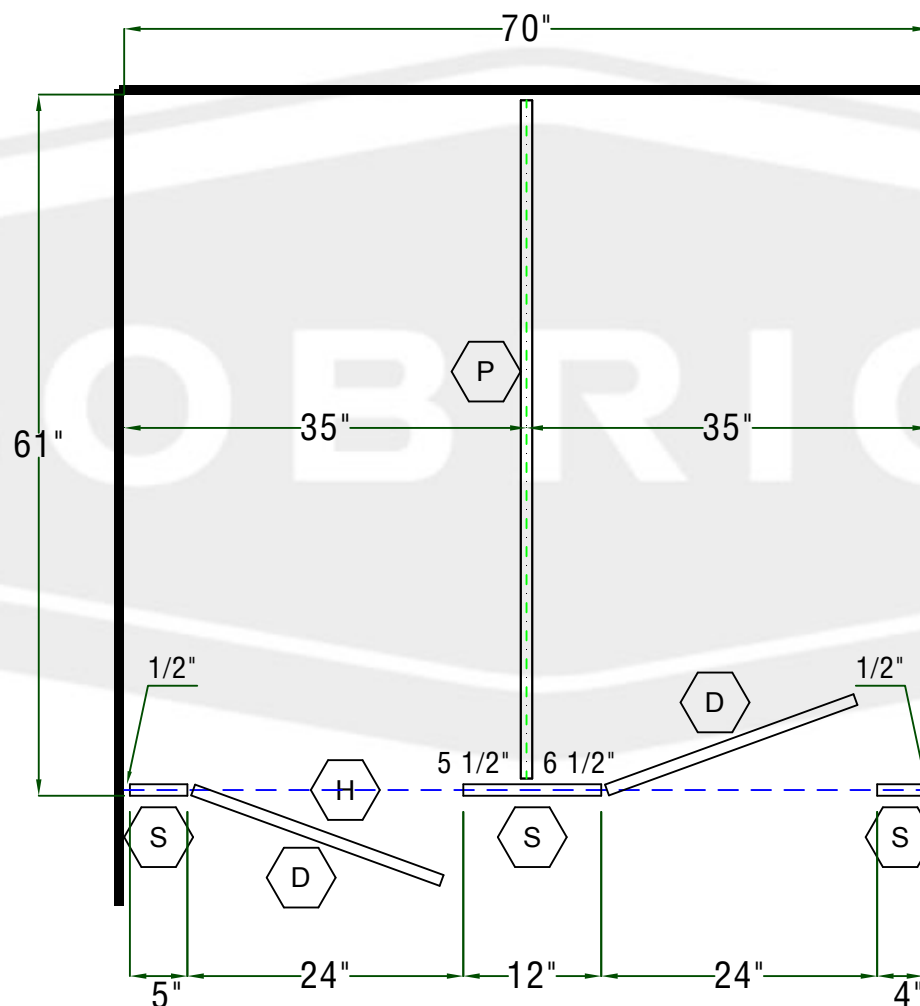

MAKE 1 UNITS THUS

EACH DRAWING MUST BE SIGNED APPROVED BEFORE FABRICATION CAN BEGIN. FABRICATION WILL BE FROM FINAL APPROVED DRAWINGS ONLY. PLEASE REVIEW CAREFULLY BEFORE SIGNING APPROVED.

1. O.A.=OVERALL GAP, 3/4" FROM WALL TO PANEL
PLUS 1/4" PANEL TO STILE
NOTES FOR INSTALLER: UNLESS OTHERWISE SPECIFIED

(S) STILE (W) WALLPOST (D) DOOR (P) PANEL (H) HEADRAIL (B) BENCH

APPROVED _____

HEIGHT	COLOR SELECTION
PANEL 58	NO COLOR 1 RR
STILE 83 5/8	NO COLOR 1 RR
DOOR 58	NO COLOR 1 RR

DISTRIBUTOR 35205 - FRY SPECIALTY INC
 QUOTE#/S.O.# 9049464-1
 P.O.#
 DATE 4/18/2024

JOB NAME Creative Quality Const.
 ROOM Men 161

Note: Dimensions are in inches

Toilet partition and urinal screen layout drawings are the sole, confidential and proprietary property of Bobrick Washroom Equipment, Inc. The layout drawings are custom designed and prepared exclusively for the quotation and manufacture of Bobrick toilet partitions and urinal screens for the distributor and job name stated on the layout. Reproduction or distribution of the layout drawings to other toilet partition manufacturers or other persons without the prior written permission of Bobrick Washroom Equipment is strictly prohibited.

FLOOR CLEARANCE 12

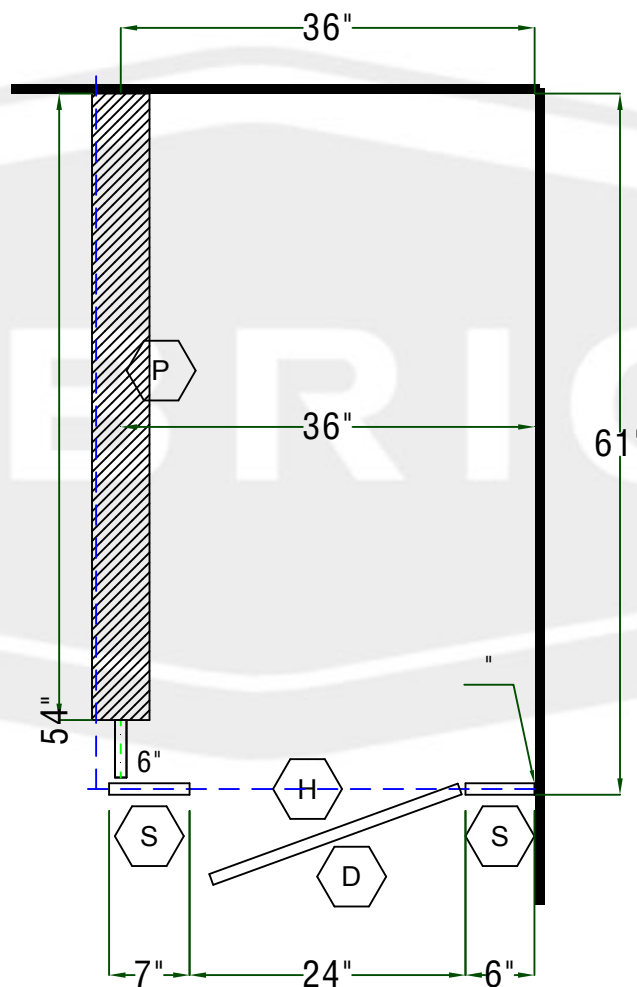

MAKE 1 UNITS THUS

1. O.A.=OVERALL GAP, 3/4" FROM WALL TO PANEL
 PLUS 1/4" PANEL TO STILE
 NOTES FOR INSTALLER: UNLESS OTHERWISE SPECIFIED

(S) STILE (W) WALLPOST (D) DOOR (P) PANEL (H) HEADRAIL (B) BENCH

EACH DRAWING MUST BE SIGNED APPROVED BEFORE FABRICATION CAN
 BEGIN. FABRICATION WILL BE FROM FINAL APPROVED DRAWINGS ONLY.
 PLEASE REVIEW CAREFULLY BEFORE SIGNING APPROVED.

APPROVED _____

HEIGHT

PANEL 58
STILE 83 5/8
DOOR 58

COLOR SELECTION

NO COLOR 1 RR
NO COLOR 1 RR
NO COLOR 1 RR

DISTRIBUTOR 35205 - FRY SPECIALTY INC

QUOTE#/S.O.# 9049464-1

P.O.#

DATE 4/18/2024

JOB NAME Creative Quality Const.

ROOM Women 102

Note: Dimensions are in inches

Toilet partition and urinal screen layout drawings are the sole, confidential and proprietary property of Bobrick Washroom Equipment, Inc. The layout drawings are custom designed and prepared exclusively for the quotation and manufacture of Bobrick toilet partitions and urinal screens for the distributor and job name stated on the layout. Reproduction or distribution of the layout drawings to other toilet partition manufacturers or other persons without the prior written permission of Bobrick Washroom Equipment is strictly prohibited.

FLOOR CLEARANCE 12

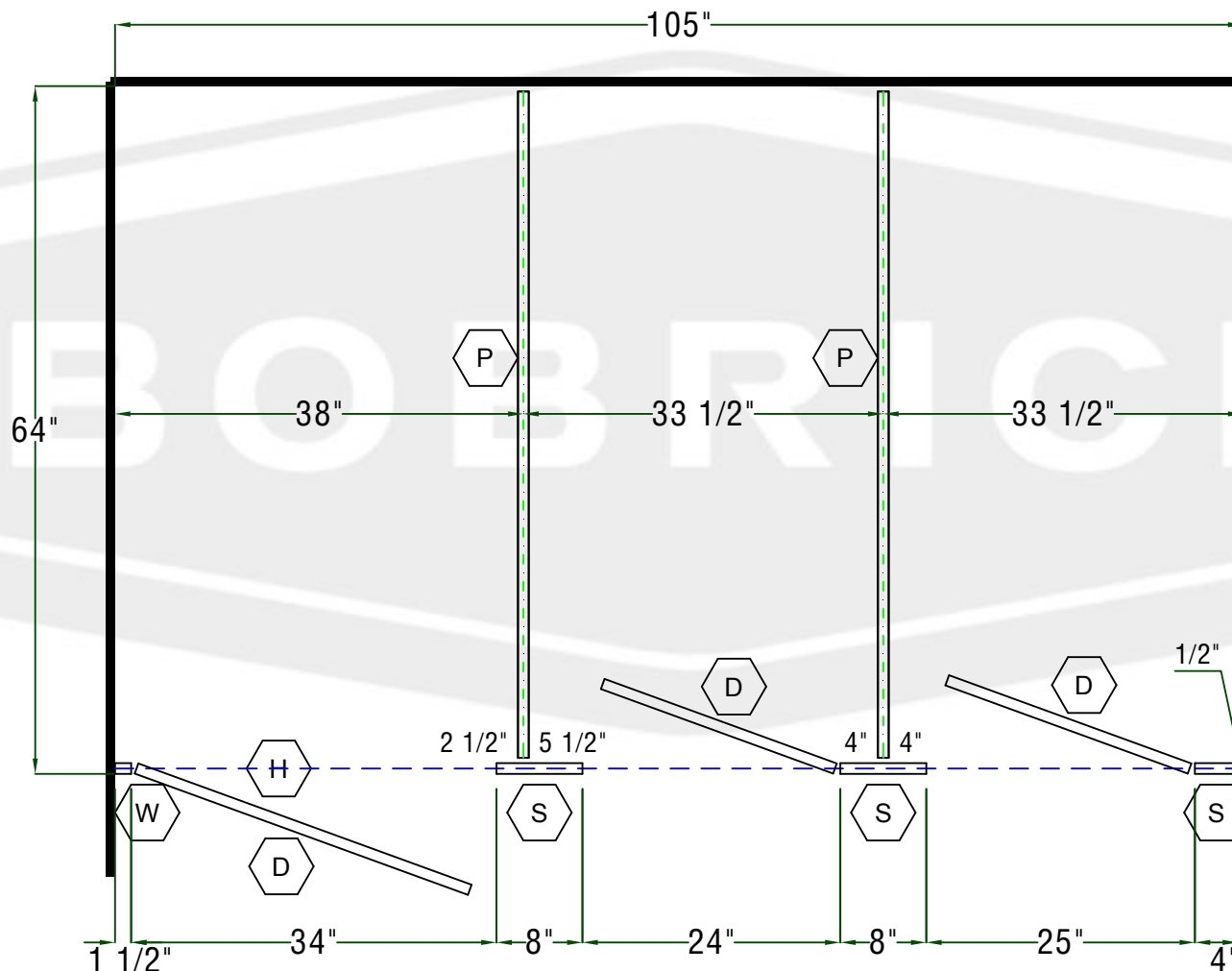

MAKE 1 UNITS THUS

EACH DRAWING MUST BE SIGNED APPROVED BEFORE FABRICATION CAN BEGIN. FABRICATION WILL BE FROM FINAL APPROVED DRAWINGS ONLY. PLEASE REVIEW CAREFULLY BEFORE SIGNING APPROVED.

1. O.A.=OVERALL GAP, 3/4" FROM WALL TO PANEL
PLUS 1/4" PANEL TO STILE
NOTES FOR INSTALLER: UNLESS OTHERWISE SPECIFIED

(S) STILE (W) WALLPOST (D) DOOR (P) PANEL (H) HEADRAIL (B) BENCH

APPROVED _____

HEIGHT	COLOR SELECTION
PANEL 58	NO COLOR 1 RR
STILE 83 5/8	NO COLOR 1 RR
DOOR 58	NO COLOR 1 RR

DISTRIBUTOR 35205 - FRY SPECIALTY INC
 QUOTE#/S.O.# 9049464-1
 P.O.#
 DATE 4/18/2024

JOB NAME Creative Quality Const.
 ROOM Men 105

Note: Dimensions are in inches

Toilet partition and urinal screen layout drawings are the sole, confidential and proprietary property of Bobrick Washroom Equipment, Inc. The layout drawings are custom designed and prepared exclusively for the quotation and manufacture of Bobrick toilet partitions and urinal screens for the distributor and job name stated on the layout. Reproduction or distribution of the layout drawings to other toilet partition manufacturers or other persons without the prior written permission of Bobrick Washroom Equipment is strictly prohibited.

FLOOR CLEARANCE 12

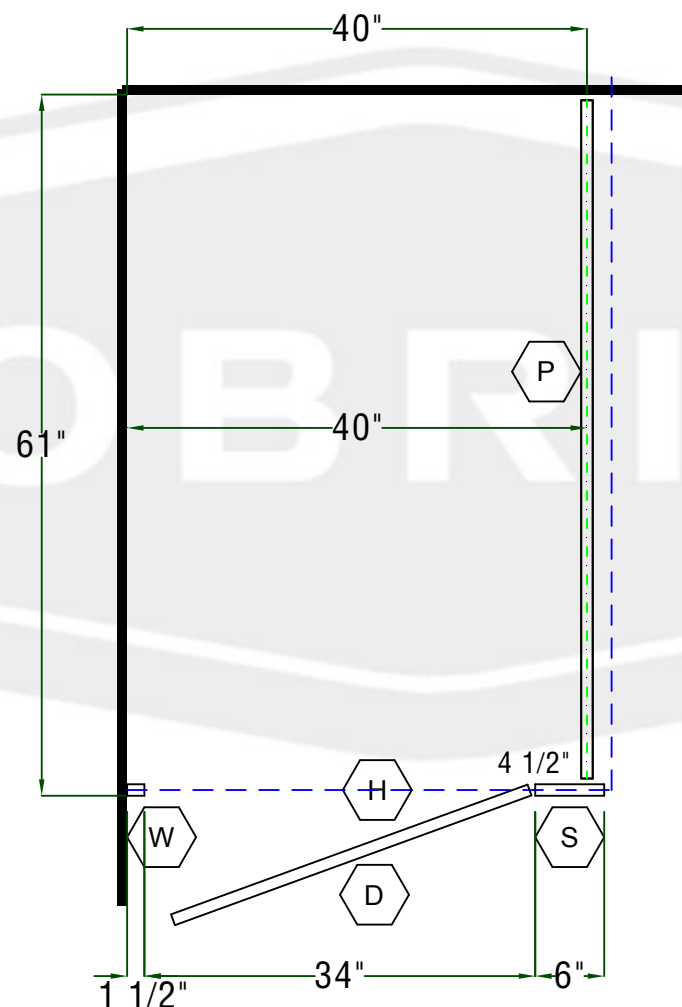

MAKE 1 UNITS THUS

1. O.A.=OVERALL GAP, 3/4" FROM WALL TO PANEL
 PLUS 1/4" PANEL TO STILE
 NOTES FOR INSTALLER: UNLESS OTHERWISE SPECIFIED

STILE WALLPOST DOOR PANEL HEADRAIL BENCH

EACH DRAWING MUST BE SIGNED APPROVED BEFORE FABRICATION CAN
 BEGIN. FABRICATION WILL BE FROM FINAL APPROVED DRAWINGS ONLY.
 PLEASE REVIEW CAREFULLY BEFORE SIGNING APPROVED.

APPROVED _____

HEIGHT		COLOR SELECTION	DISTRIBUTOR	35205 - FRY SPECIALTY INC		Note: Dimensions are in inches
PANEL	58	NO COLOR 1 RR	QUOTE#/S.O.#	9049464-1		
STILE	83 5/8	NO COLOR 1 RR	P.O.#	JOB NAME	Creative Quality Const.	
DOOR	58	NO COLOR 1 RR	DATE	4/18/2024	ROOM	

Toliet partition and urinal screen layout drawings are the sole, confidential and proprietary property of Bobrick Washroom Equipment, Inc. The layout drawings are custom designed and prepared exclusively for the quotation and manufacture of Bobrick toilet partitions and urinal screens for the distributor and job name stated on the layout. Reproduction or distribution of the layout drawings to other toilet partition manufacturers or other persons without the prior written permission of Bobrick Washroom Equipment is strictly prohibited.



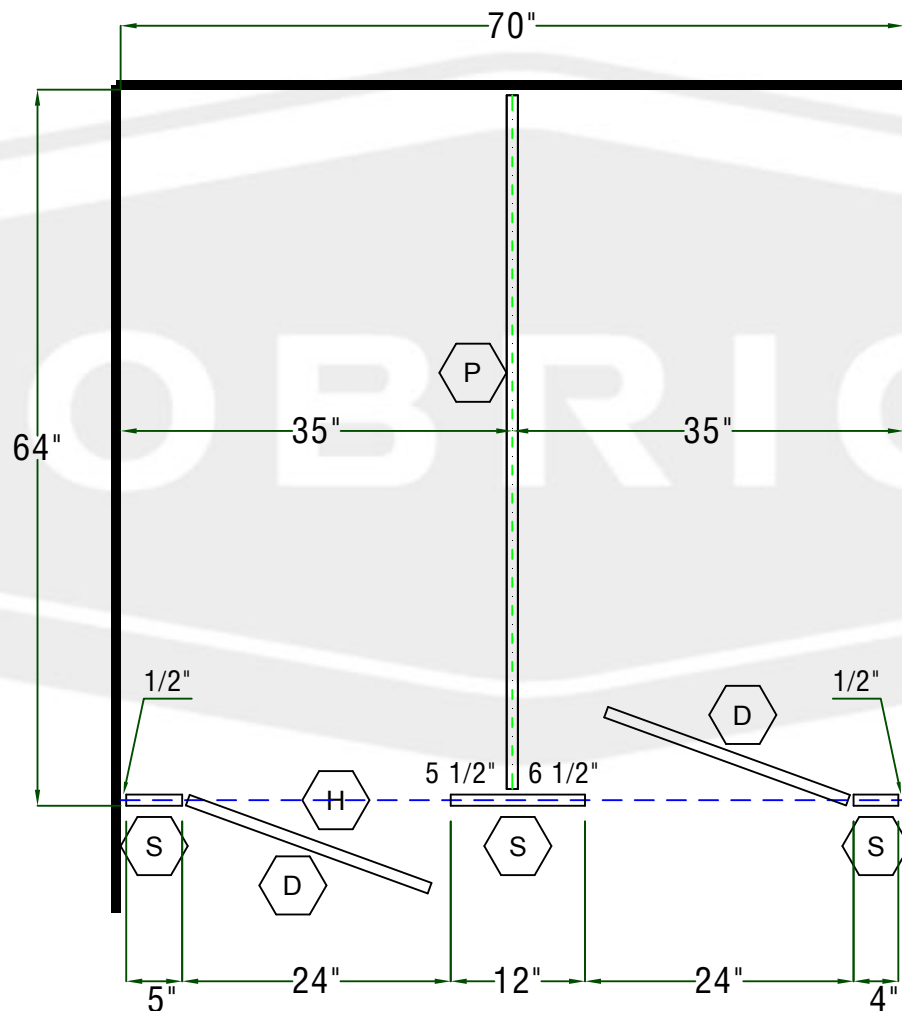



FLOOR CLEARANCE 12



MAKE 1 UNITS THUS

EACH DRAWING MUST BE SIGNED APPROVED BEFORE FABRICATION CAN BEGIN. FABRICATION WILL BE FROM FINAL APPROVED DRAWINGS ONLY. PLEASE REVIEW CAREFULLY BEFORE SIGNING APPROVED.

1. O.A.=OVERALL GAP, 3/4" FROM WALL TO PANEL
PLUS 1/4" PANEL TO STILE
NOTES FOR INSTALLER: UNLESS OTHERWISE SPECIFIED

 STILE  WALLPOST  DOOR  PANEL  HEADRAIL  BENCH

APPROVED

HEIGHT	COLOR SELECTION
PANEL 58	NO COLOR 1 RR
STILE 83 5/8	NO COLOR 1 RR
DOOR 58	NO COLOR 1 RR

DISTRIBUTOR 35205 - FRY SPECIALTY INC
 QUOTE#/S.O.# 9049464-1
 P.O.#
 DATE 4/18/2024

JOB NAME Creative Quality Const.
 ROOM Men 136

Note: Dimensions are in inches

Toilet partition and urinal screen layout drawings are the sole, confidential and proprietary property of Bobrick Washroom Equipment, Inc. The layout drawings are custom designed and prepared exclusively for the quotation and manufacture of Bobrick toilet partitions and urinal screens for the distributor and job name stated on the layout. Reproduction or distribution of the layout drawings to other toilet partition manufacturers or other persons without the prior written permission of Bobrick Washroom Equipment is strictly prohibited.

FLOOR CLEARANCE 12

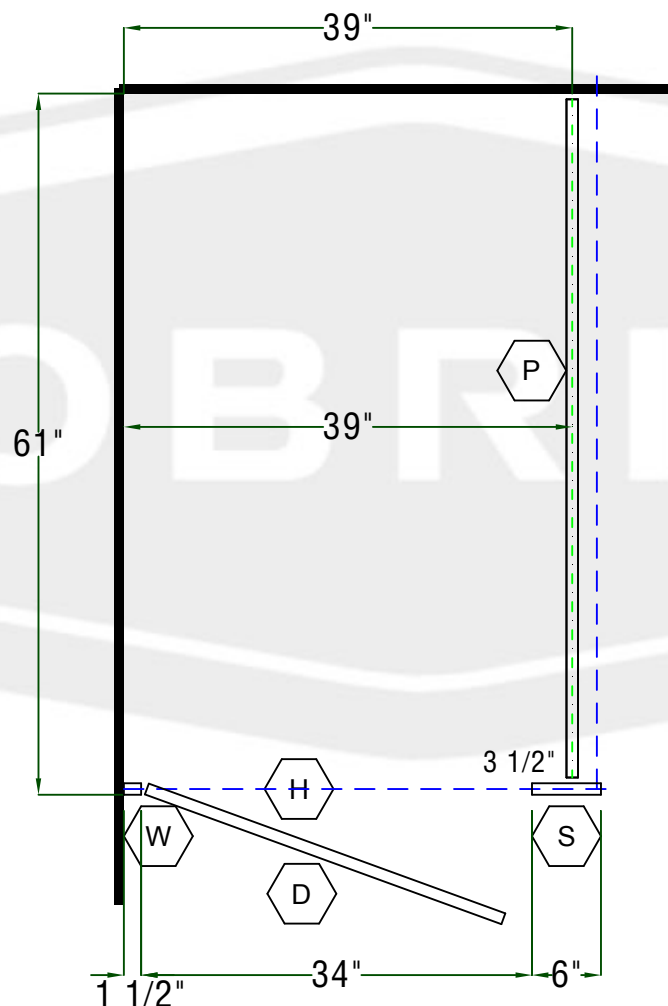

MAKE 1 UNITS THUS

1. O.A.=OVERALL GAP, 3/4" FROM WALL TO PANEL
 PLUS 1/4" PANEL TO STILE
 NOTES FOR INSTALLER: UNLESS OTHERWISE SPECIFIED

(S) STILE (W) WALLPOST (D) DOOR (P) PANEL (H) HEADRAIL (B) BENCH

EACH DRAWING MUST BE SIGNED APPROVED BEFORE FABRICATION CAN BEGIN. FABRICATION WILL BE FROM FINAL APPROVED DRAWINGS ONLY. PLEASE REVIEW CAREFULLY BEFORE SIGNING APPROVED.

APPROVED _____

HEIGHT
PANEL 58
STILE 83 5/8
DOOR 58

COLOR SELECTION
NO COLOR 1 RR
NO COLOR 1 RR
NO COLOR 1 RR

DISTRIBUTOR 35205 - FRY SPECIALTY INC
QUOTE#/S.O.# 9049464-1
P.O.#
DATE 4/18/2024

JOB NAME Creative Quality Const.
ROOM Women 121

Note: Dimensions are in inches

Toilet partition and urinal screen layout drawings are the sole, confidential and proprietary property of Bobrick Washroom Equipment, Inc. The layout drawings are custom designed and prepared exclusively for the quotation and manufacture of Bobrick toilet partitions and urinal screens for the distributor and job name stated on the layout. Reproduction or distribution of the layout drawings to other toilet partition manufacturers or other persons without the prior written permission of Bobrick Washroom Equipment is strictly prohibited.

FLOOR CLEARANCE 12

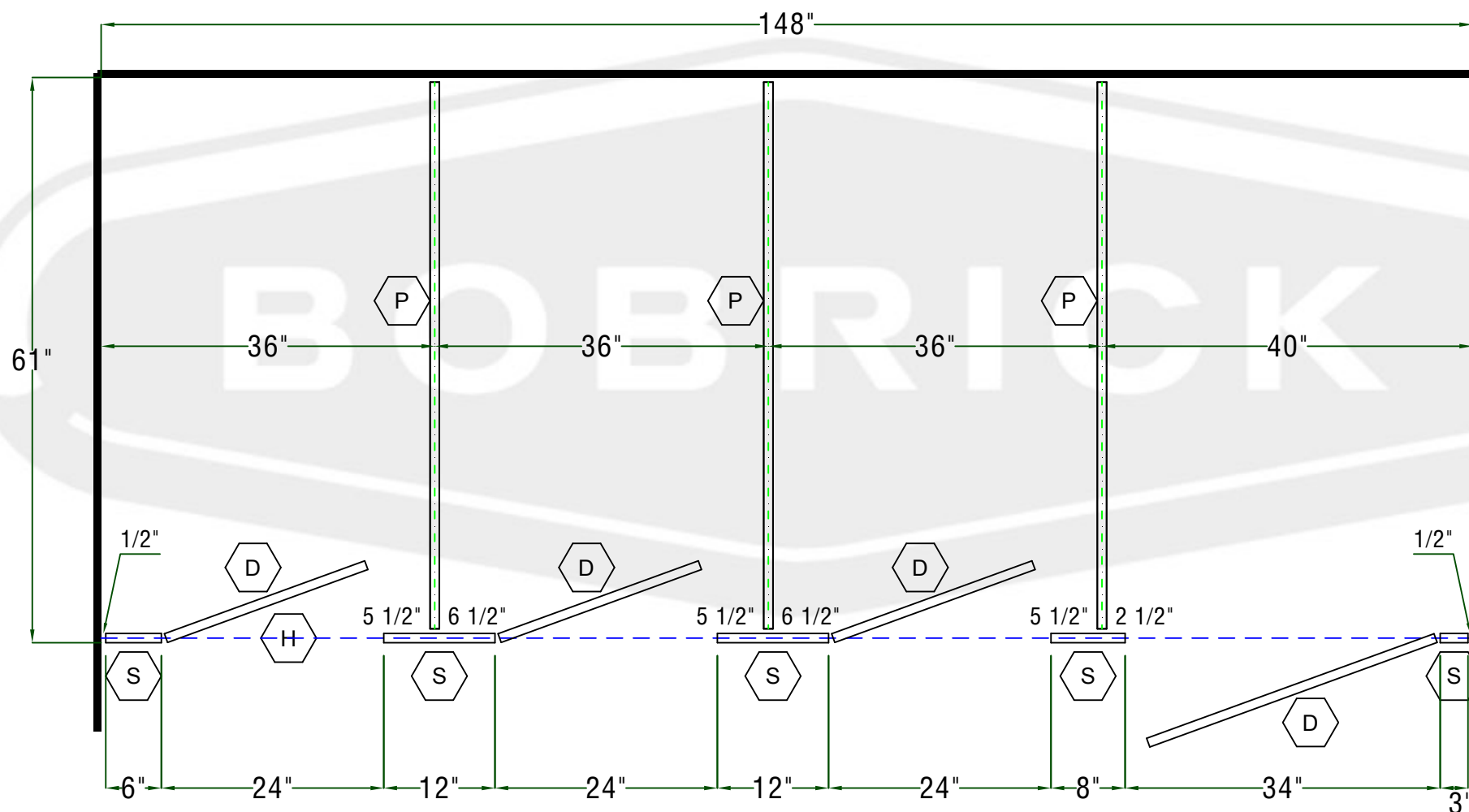

EACH DRAWING MUST BE SIGNED APPROVED BEFORE FABRICATION CAN BEGIN. FABRICATION WILL BE FROM FINAL APPROVED DRAWINGS ONLY. PLEASE REVIEW CAREFULLY BEFORE SIGNING APPROVED.

APPROVED _____

HEIGHT	COLOR SELECTION
PANEL 58	NO COLOR 1 RR
STILE 83 5/8	NO COLOR 1 RR
DOOR 58	NO COLOR 1 RR

DISTRIBUTOR 35205 - FRY SPECIALTY INC
 QUOTE#/S.O.# 9049464-1
 P.O.#
 DATE 4/18/2024

JOB NAME Creative Quality Const.
 ROOM Men 120

Note: Dimensions are in inches

Toilet partition and urinal screen layout drawings are the sole, confidential and proprietary property of Bobrick Washroom Equipment, Inc. The layout drawings are custom designed and prepared exclusively for the quotation and manufacture of Bobrick toilet partitions and urinal screens for the distributor and job name stated on the layout. Reproduction or distribution of the layout drawings to other toilet partition manufacturers or other persons without the prior written permission of Bobrick Washroom Equipment is strictly prohibited.

FLOOR CLEARANCE 12

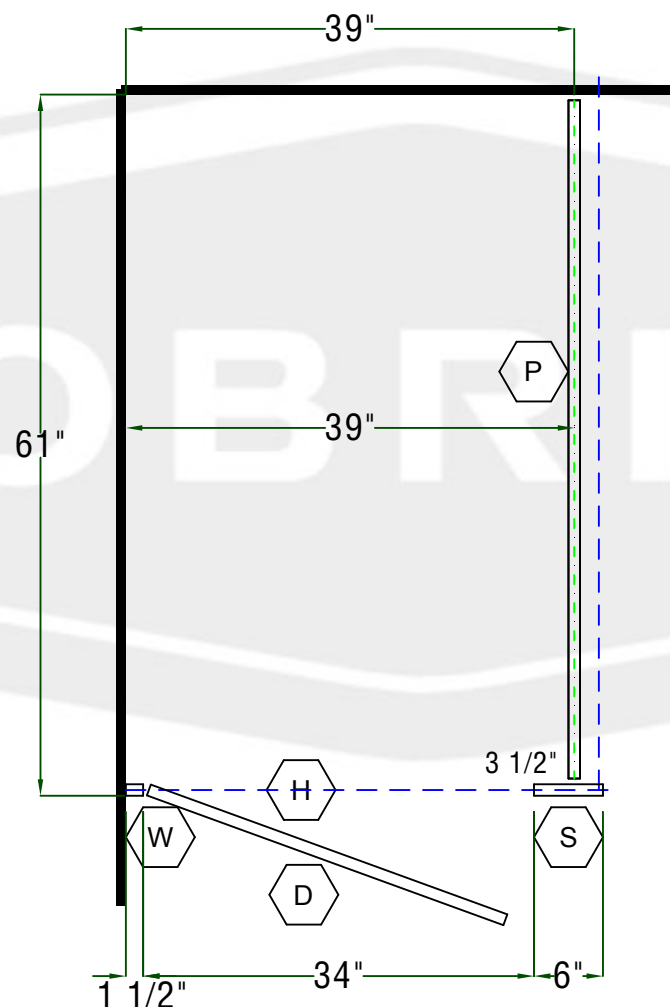

MAKE 1 UNITS THUS

1. O.A.=OVERALL GAP, 3/4" FROM WALL TO PANEL
 PLUS 1/4" PANEL TO STILE
 NOTES FOR INSTALLER: UNLESS OTHERWISE SPECIFIED

STILE
 WALLPOST
 DOOR
 PANEL
 HEADRAIL
 BENCH

EACH DRAWING MUST BE SIGNED APPROVED BEFORE FABRICATION CAN BEGIN. FABRICATION WILL BE FROM FINAL APPROVED DRAWINGS ONLY. PLEASE REVIEW CAREFULLY BEFORE SIGNING APPROVED.

APPROVED _____

COLOR SELECTION

NO COLOR 1 RR
NO COLOR 1 RR
NO COLOR 1 RR

DISTRIBUTOR 35205 - FRY SPECIALTY INC

QUOTE#/S.O.# 9049464-1

P.O.#

DATE 4/18/2024

JOB NAME Creative Quality Const.

ROOM Men 120

Note: Dimensions are in inches

Toilet partition and urinal screen layout drawings are the sole, confidential and proprietary property of Bobrick Washroom Equipment, Inc. The layout drawings are custom designed and prepared exclusively for the quotation and manufacture of Bobrick toilet partitions and urinal screens for the distributor and job name stated on the layout. Reproduction or distribution of the layout drawings to other toilet partition manufacturers or other persons without the prior written permission of Bobrick Washroom Equipment is strictly prohibited.

FLOOR CLEARANCE 12

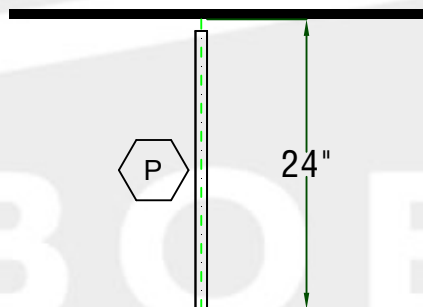

PLAN VIEW

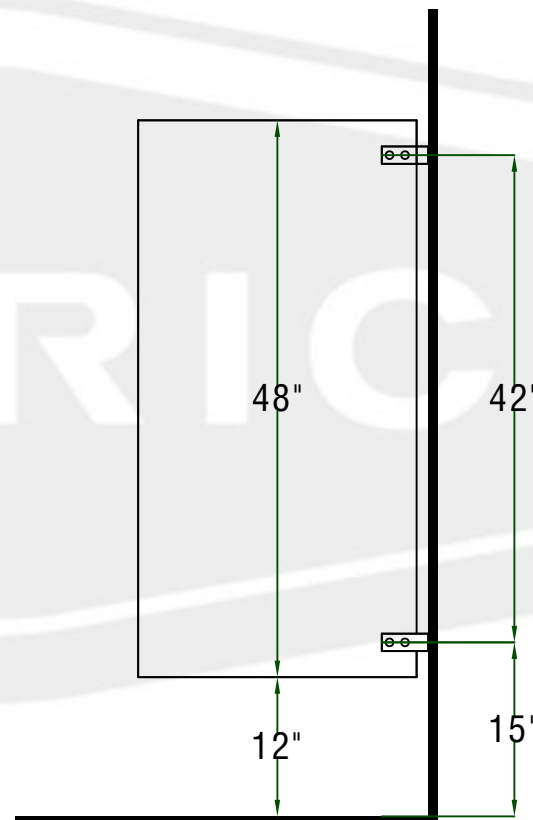

SIDE VIEW

MAKE 1 UNITS THUS

1. O.A.=OVERALL GAP, 3/4" FROM WALL TO PANEL
PLUS 1/4" PANEL TO STILE
NOTES FOR INSTALLER: UNLESS OTHERWISE SPECIFIED



STILE



WALLPOST



DOOR



PANEL



HEADRAIL



BENCH

EACH DRAWING MUST BE SIGNED APPROVED BEFORE FABRICATION CAN
BEGIN. FABRICATION WILL BE FROM FINAL APPROVED DRAWINGS ONLY.
PLEASE REVIEW CAREFULLY BEFORE SIGNING APPROVED.

APPROVED _____

COLOR SELECTION

NO COLOR 1 RR

NO COLOR 1 RR

NO COLOR 1 RR

DISTRIBUTOR 35205 - FRY SPECIALTY INC

QUOTE#/S.O.# 9049464-1

P.O.#

DATE 4/18/2024

JOB NAME Creative Quality Const.

ROOM Men 105

Note: Dimensions are in inches

Toilet partition and urinal screen layout drawings are the sole, confidential and proprietary property of Bobrick Washroom Equipment, Inc. The layout drawings are custom designed and prepared exclusively for the quotation and manufacture of Bobrick toilet partitions and urinal screens for the distributor and job name stated on the layout. Reproduction or distribution of the layout drawings to other toilet partition manufacturers or other persons without the prior written permission of Bobrick Washroom Equipment is strictly prohibited.

FLOOR CLEARANCE 12

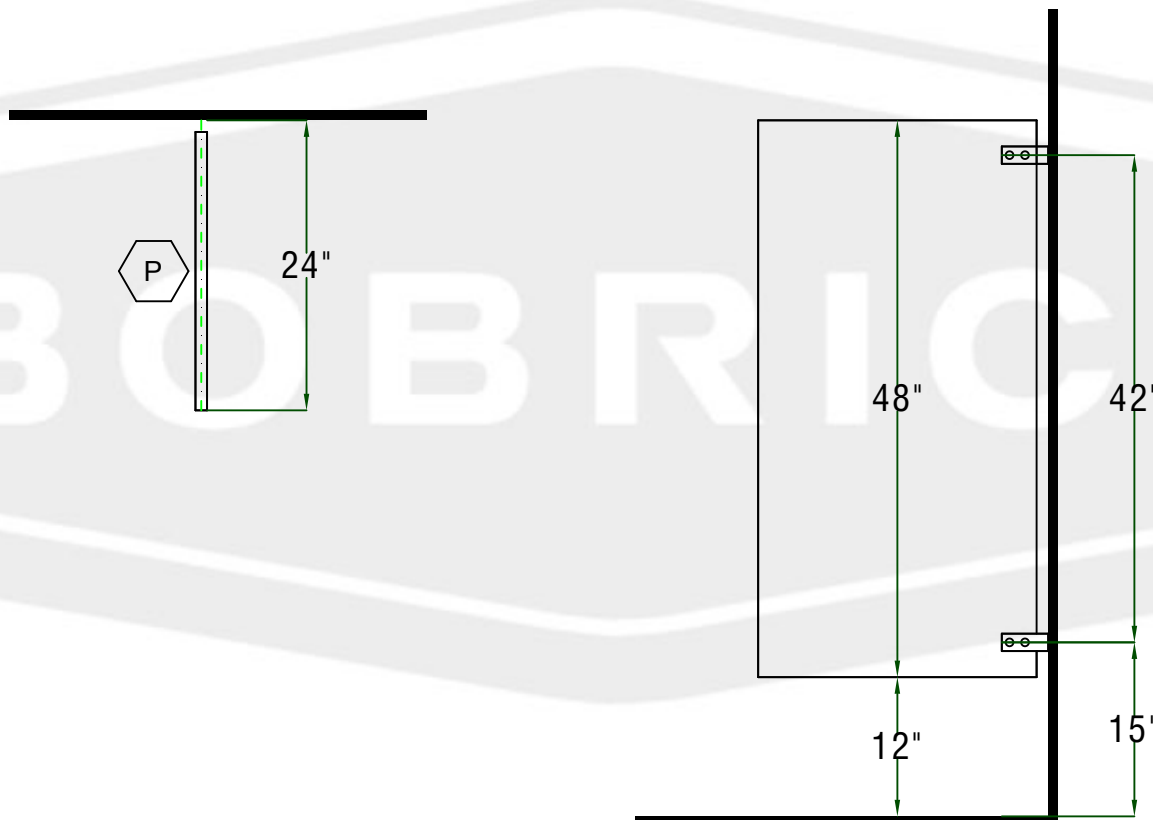

PLAN VIEW

SIDE VIEW

MAKE 4 UNITS THUS

1. O.A.=OVERALL GAP, 3/4" FROM WALL TO PANEL
PLUS 1/4" PANEL TO STILE
NOTES FOR INSTALLER: UNLESS OTHERWISE SPECIFIED



STILE



WALLPOST



DOOR



PANEL



HEADRAIL



BENCH

EACH DRAWING MUST BE SIGNED APPROVED BEFORE FABRICATION CAN
BEGIN. FABRICATION WILL BE FROM FINAL APPROVED DRAWINGS ONLY.
PLEASE REVIEW CAREFULLY BEFORE SIGNING APPROVED.

APPROVED _____

COLOR SELECTION

NO COLOR 1 RR

NO COLOR 1 RR

NO COLOR 1 RR

DISTRIBUTOR 35205 - FRY SPECIALTY INC

QUOTE#/S.O.# 9049464-1

P.O.#

DATE 4/18/2024

JOB NAME Creative Quality Const.

ROOM Men 161

Note: Dimensions are in inches

Toilet partition and urinal screen layout drawings are the sole, confidential and proprietary property of Bobrick Washroom Equipment, Inc. The layout drawings are custom designed and prepared exclusively for the quotation and manufacture of Bobrick toilet partitions and urinal screens for the distributor and job name stated on the layout. Reproduction or distribution of the layout drawings to other toilet partition manufacturers or other persons without the prior written permission of Bobrick Washroom Equipment is strictly prohibited.

FLOOR CLEARANCE 12

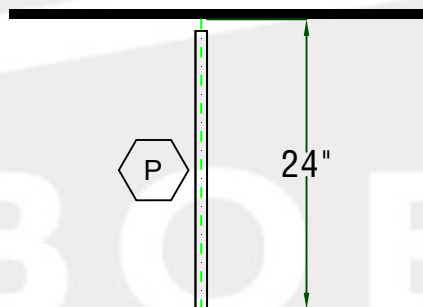

PLAN VIEW

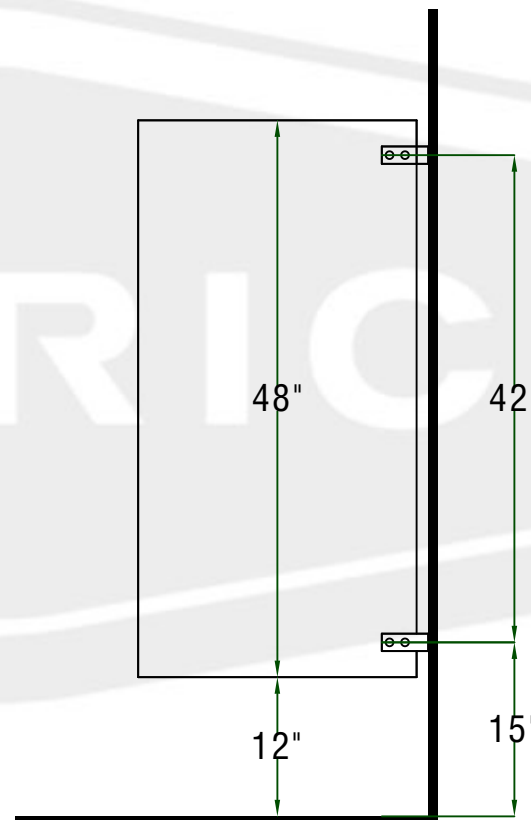

SIDE VIEW

MAKE 1 UNITS THUS

1. O.A.=OVERALL GAP, 3/4" FROM WALL TO PANEL
PLUS 1/4" PANEL TO STILE
NOTES FOR INSTALLER: UNLESS OTHERWISE SPECIFIED



STILE



WALLPOST



DOOR



PANEL



HEADRAIL



BENCH

EACH DRAWING MUST BE SIGNED APPROVED BEFORE FABRICATION CAN
BEGIN. FABRICATION WILL BE FROM FINAL APPROVED DRAWINGS ONLY.
PLEASE REVIEW CAREFULLY BEFORE SIGNING APPROVED.

APPROVED _____



HIGH PRESSURE LAMINATE (HPL) STANDARD COLORS & PATTERNS

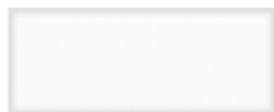

Designer White
D354-60

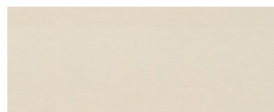

Natural Almond
D30-60



Beige
1530-60



Otter
3202-58



Shadow
D96-60



Slate Grey
D91-60

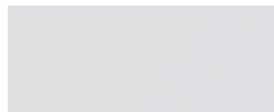

Moonstone
7872-58

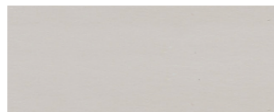

Grey
1500-60

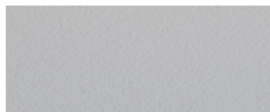

Platinum
D315-60



Mouse
928-58



Terril
2297-58



Black
1595-60



White Carrara
4924-38



Neutral Weft
5875-58



Flax Gauze
7708-58



Desert Zephyr
4841-60



Cardboard Solidz
7813-58



Pewter Mesh
4878-38



Sheer Mesh
4876-38



Classic Linen
4943-38

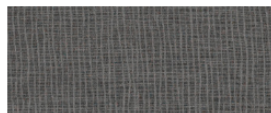

Citadel Warp
5882-58

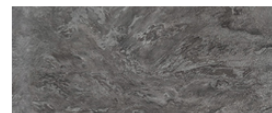

Silver Galaxy Slate
9528-58



White Ash
8841-58



Danish Maple
8906-58



Millennium Oak
5887-58



Bleached Legno
8845-58



Smoky Brown Pear
5488-58



Blackened Steel
8918-58