



## Estimate

ADDRESS  
Valued ToiletPartitions.com Customer

ESTIMATE 11406  
DATE 05/08/2024

SALES REP  
ROB 619-387-8128

JOB NAME  
TBA

ITEM	DESCRIPTION	QTY
MATERIAL TYPE	POWDER COATED STEEL	
STYLE	FLOOR ANCHORED/OVERHEAD BRACED	
COLOR	STANDARD - TBA	
HARDWARE	STANDARD	
STALLS	INCLUDED	3
DIVIDER	MENS URINAL	
LEAD TIME	STANDARD COLOR 3-6 BIZ DAYS	
SHIPPING	SHIPPING INCLUDED FOR COMMERCIAL ADDRESS IN ZIP CODE: 92707	
*NOTE	*LIFTGATE \$125.00 (REQUIRED IF LOADING DOCK OR FORKLIFT IS NOT AVAILABLE *NOTIFICATION CALL \$40.00 *RESIDENTIAL/CHURCH \$95.00	

\*\*\* Sales tax will be added if shipping to: AZ, CA, FL, GA, IL, MD, MA, MI, MN, NJ, NY, NC, OK, TN, TX, VA, AND WA.

SUBTOTAL	1,722.05
TAX (0%)	0.00
TOTAL	<b>\$1,722.05</b>

Accepted By

Accepted Date



## POWDER COATED METAL COLOR CARD

### QUICK SHIP COLORS

\*Delivered in 3-6 Business Days

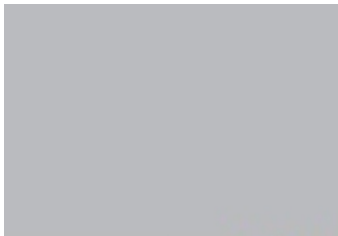

535 LIGHT GREY



621 SLATE



545 CHARCOAL

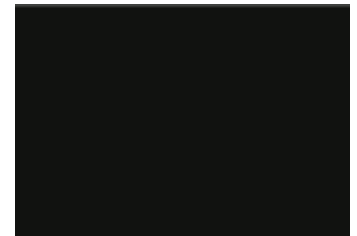

510 BLACK



609 COLONIAL BLUE

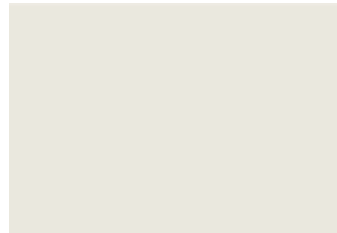

504 LINEN

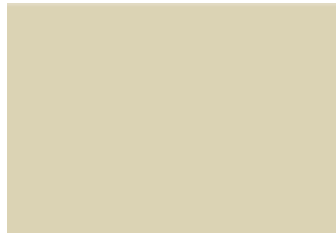

603 ALMOND



532 LATTE

### STANDARD COLORS

\*Delivered in 12-18 Business Days

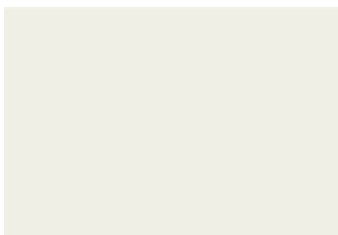

541 EXTRA WHITE



500 WHITE



585 SAHARA

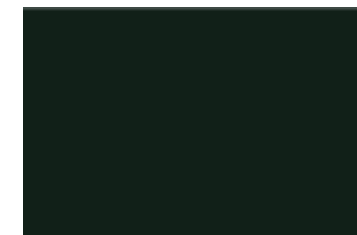

581 MOSS GREEN



639 SAPPHIRE BLUE

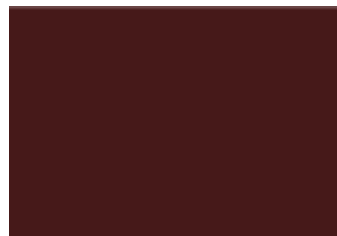

607 BORDEAUX



576 RUBY RED

## Drawing Notes

- Compartment widths on drawings are shown at center line of panels.
- Compartment depths on drawings are shown from front face of pilaster to finished wall.
- Cut headrail in field to suit (if applicable).
- "X" on drawings indicates that backing is required.
- Fabrication will not commence until approval has been received.
- Material supplied will conform to the dimensions indicated on drawings.
- Scale of drawings - none.
-  on drawings indicates location of pilaster reinforcing channel(s).



Project Title	CPR Support	Created By	Javier Solis	Last edit date	05/08/2024	Distributor	Fry Specialty Inc.
Drawing Title	RR	Date Printed	05/08/2024	Quote Number	Q0741594.001		

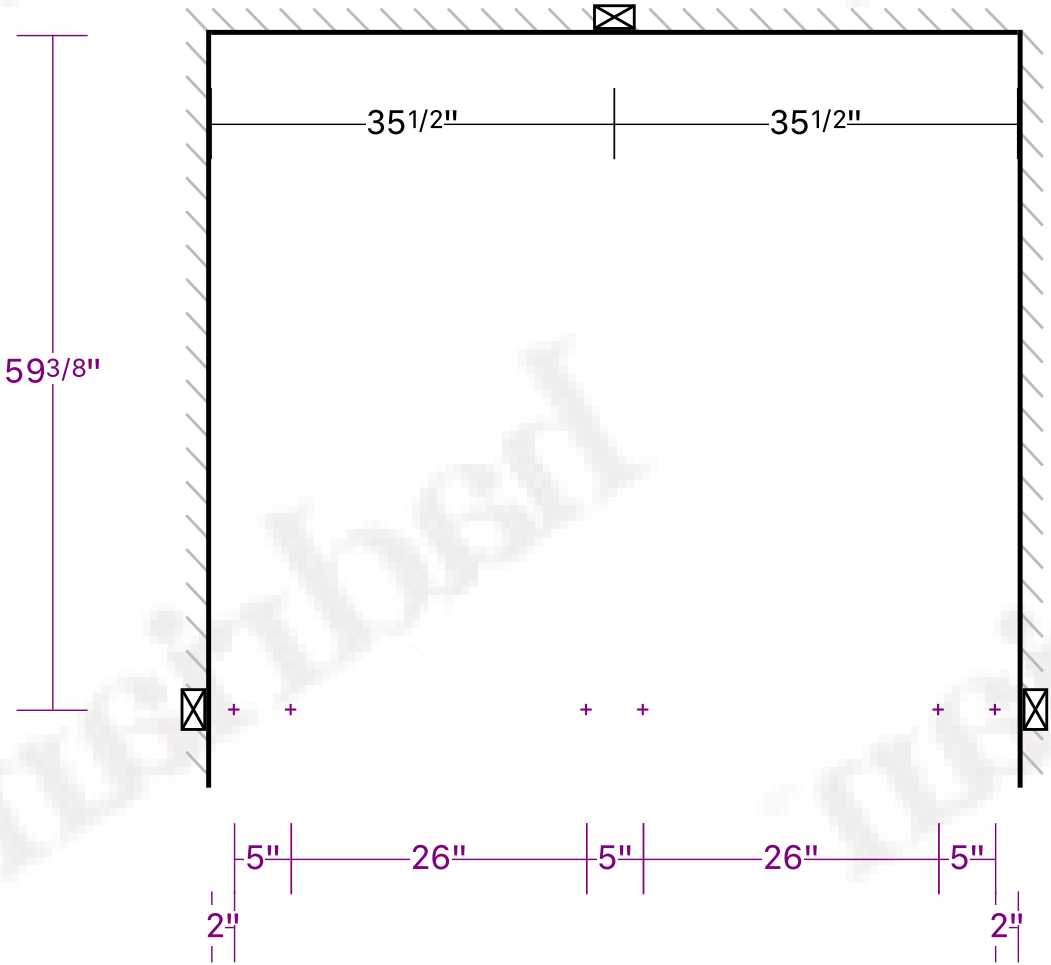

LEGEND			Unit	
Product	Toilet Partitions	Material	Powder Coated	Panel/Door height = 58"
Series	Standard	AFF	12"	Panel/Door AFF = 12"
Sightline Option	None	Hinge	Wrap	
		Finish	TBA - Color TBA	
		Hardware	Standard Chrome	
		Latch	Concealed	
		Partition	Floor Mounted	
		Options	None	

<b>Project Title</b>	CPR Support	<b>Created By</b>	Javier Solis	<b>Last edit date</b>	05/08/2024	<b>Distributor</b>	Fry Specialty Inc.
<b>Drawing Title</b>	RR	<b>Date Printed</b>	05/08/2024	<b>Quote Number</b>	Q0741594.001		

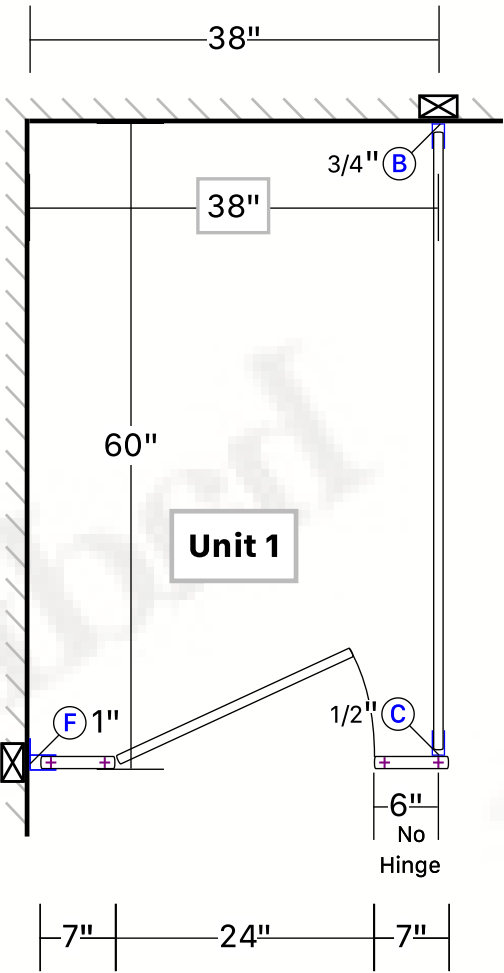

<div>LEGEND</div> <div><div>B</div>F Bracket</div> <div><div>C</div>U Clip</div> <div><div>F</div>Pilaster F Bracket</div>				<div>Unit</div> <div>Panel/Door height = 58"</div> <div>Panel/Door AFF = 12"</div>			
Product	Toilet Partitions	Material	Powder Coated	Finish	TBA - Color TBA	Partition	Floor Mounted
Series	Standard	AFF	12"	Hardware	Standard Chrome	Options	None
Sightline Option	None	Hinge	Wrap	Latch	Concealed		

Project Title	CPR Support	Created By	Javier Solis	Last edit date	05/08/2024	Distributor	Fry Specialty Inc.
Drawing Title	RR	Date Printed	05/08/2024	Quote Number	Q0741594.001		



LEGEND				<div>Unit</div> <div>Panel/Door height = 58" Panel/Door AFF = 12"</div>			
Product	Toilet Partitions	Material	Powder Coated	Finish	TBA - Color TBA	Partition	Floor Mounted
Series	Standard	AFF	12"	Hardware	Standard Chrome	Options	None
Sightline Option	None	Hinge	Wrap	Latch	Concealed		

## Recommended Methods for Attaching to a Wall

The details below demonstrate the recommended methods for attaching panels and pilasters to common wall types. Other wall types may be encountered. In all cases, proper wall backing is required to achieve a successful toilet partition installation.

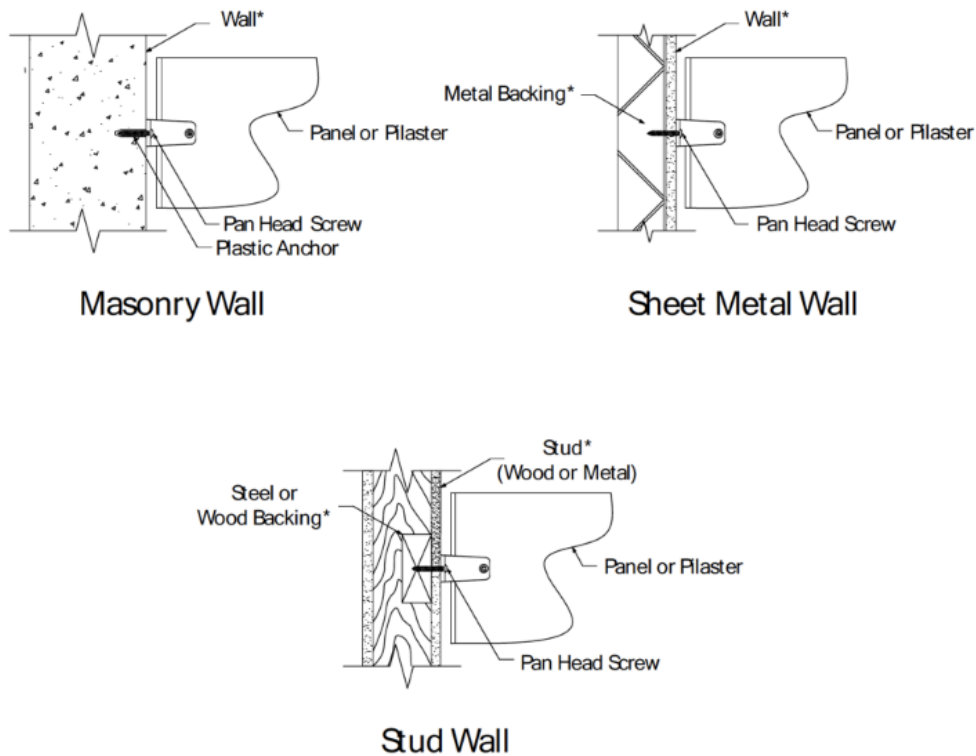

\*Not Supplied by Hadrian



# Material Specification

## FLOOR MOUNTED - POWDER COATED METAL TOILET PARTITIONS - STANDARD

### 1.01 Construction Features

Doors, Panels and Pilasters shall be constructed of two sheets of panel flatness zinc - coated galvalume steel, ASTM A653 GR33, laminated under pressure to a honeycomb core for sound deadening and rigidity. Formed edges to be welded together and inter - locked under tension with a roll - formed oval crown locking bar, mitred, welded and ground smooth at the corners. Honeycomb to have a maximum 25 mm (1") cell size.

### 1.02 Doors

Shall be 1461mm (57.5") high and 25mm (1") thick with cover sheets not less than 0.8mm (.030").

### 1.03 Panels

Shall be 1461mm (57.5") high and (1") thick with cover sheets not less than 0.8mm (.030").

### 1.04 Pilasters

Shall be 32mm (1.25") thick with cover sheets not less than 1.2mm (.048").

### 1.05 Pilaster Fastening Method

Pilasters shall be securely and rigidly fastened to the floor using 19mm (.75") diameter expansion shields with spacer and nuts for levelling of pilaster. Floors, preferably concrete, should not be less than 127mm (5") thick for rigidity and anchorage. The floor fastening shall be concealed and protected by a 102mm (4") high, die-formed stainless steel pilaster shoe.

### 1.06 Hardware and Fittings

All panel and pilaster brackets and all door hardware shall be chrome plated zinc die castings.

Fasteners are zinc plated 12 x 1-3/4" and 12 x 5/8" TR-27 6-lobe security screws.

Doors shall be equipped with chrome plated zinc die cast gravity type hinges, mounted on upper and lower pilaster hinge brackets. Threaded top hinge pin shall be metal with a self-lubricating nylon sleeve. Door hinges shall be wrap-around style and adjustable to permit the door to come to rest at any position when not latched.

Coat Hook and Bumper: Each door to be fitted with a combined coat hook and bumper. Finish to match other hardware items.

Latch to be a concealed, chrome plated zinc die casting with face mortised flush with edge strip of door.

The combined stop and keeper shall have a 19mm (0.75") diameter bumper locked in place. Finish to match other hardware items.

Pilaster shoes to be stainless steel with a #4 brushed finish.

### 1.07 Finish

All sheet metal to be thoroughly cleaned, phosphated and finished with a high performance powder coating, baked on to provide a uniform smooth protective finish. Color shall be as selected from Hadrian's color card.

This specification applies to room(s): RR, RR

**Metal Toilet Partitions**  
**Standard Series - Floor Mounted - 12" [305mm] AFF**  
**Chrome - Concealed Latch & Wrap Hinge**

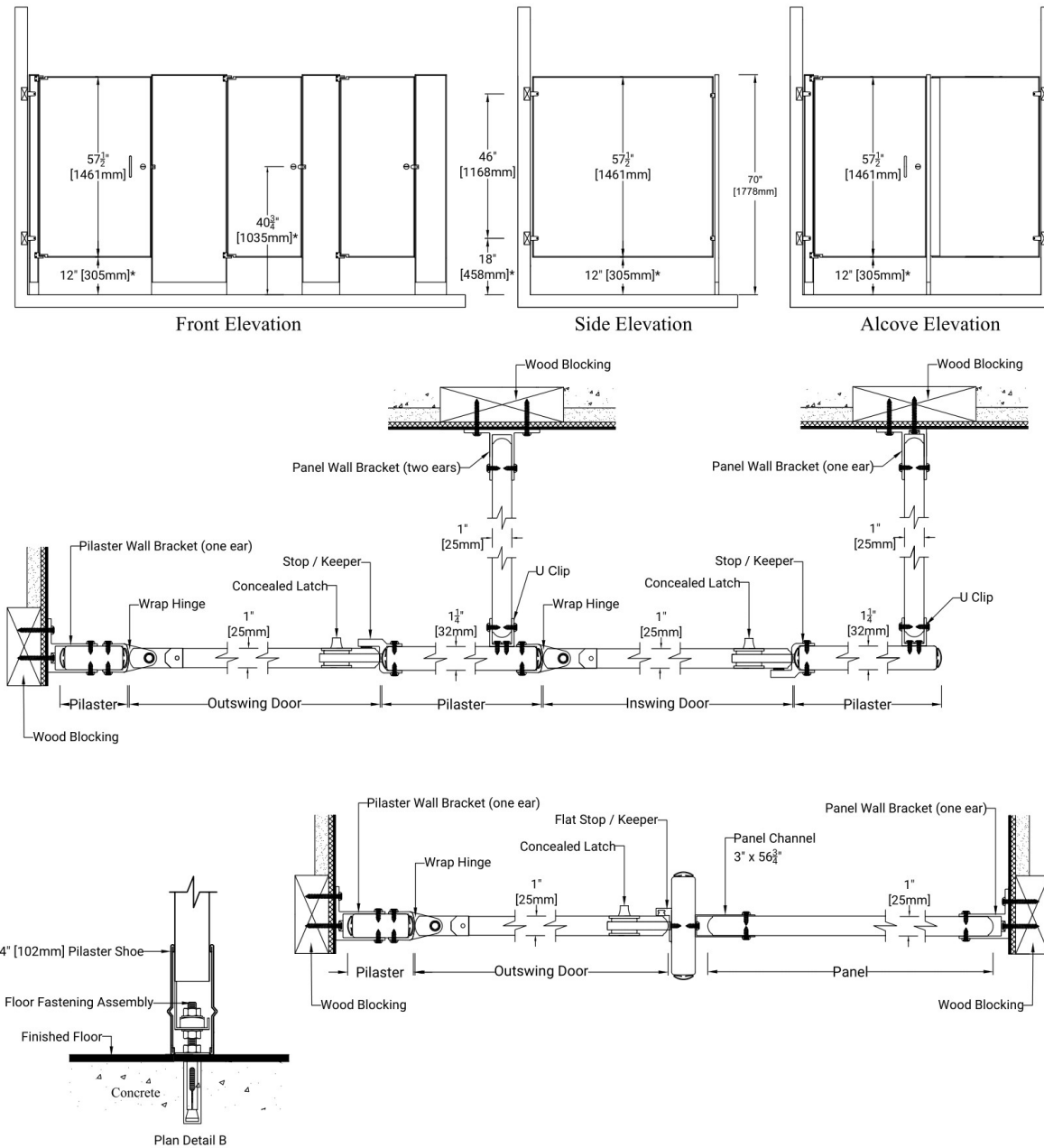

**Important Notes:**

Refer to final drawings for wood blocking information. Wood blocking is critical to ensure a rigid installation. See material specifications for material and hardware finishes.

\*Above finish floor dimensions may vary due to floor level and cam position

## Warranty Information

Hadrian Manufacturing Inc. ("Hadrian") provides the following warranty with respect to the Hadrian product(s) supplied for the project indicated above.

Subject to the terms set out herein, the product(s) are warranted against defects in material and workmanship from the date of receipt by the authorized Hadrian distributor for the warranty period outlined below:

Powder Coated Toilet Partitions	3 years
Stainless Steel Toilet Partitions	5 years
Solid Plastic Toilet Partitions	25 years
Phenolic Black Core Toilet Partitions	25 years
Emperor (corridor) Lockers	2 years
Gladiator (athletic) Lockers	5 years
Replacement Front Lockers	2 years
Boot Racks	1 year

The warranty is for Hadrian material only and excludes damages caused by installation errors, vandalism, improper usage, improper maintenance, exposure to harsh environments or chemicals (such as chlorine, bromine, etc.) or failure of the building structure to adequately support the product. Site preparations (i.e. wood blocking, etc.) must meet final drawing specifications and Hadrian's recommended maintenance procedure must be followed.

The exclusive remedy under this warranty shall, at Hadrian's discretion, be replacement or repair of the defective material. Hadrian will not pay any removal, installation or other labor costs associated with the repair or replacement. Replacement material will be warranted for the unused portion of the original warranty period.

No warranty of merchantability or fitness for a particular purpose is made or implied. In no event shall Hadrian be liable for any other costs or damages, including loss of profit, loss of revenue, indirect, incidental, special or consequential damages howsoever arising, whether under warranty, contract, statute, tort, equity or otherwise.

This warranty extends only to the original authorized Hadrian customer and is non-transferable. Warranty claims must be made during the applicable warranty period and initiated by contacting Hadrian at the following coordinates: USA: 440-942-9118 / CANADA: 905-333-0300.

The foregoing constitutes the entire warranty given by Hadrian and no one is authorized to change or expand this warranty on behalf of Hadrian.



**Hadrian Manufacturing Inc.**, 965 Syscon Road, Burlington, ON, L7L 5S3 T: 905-333-0300 F: 905-333-1841  
**Hadrian Manufacturing Inc.**, 2550 - 61 Avenue SE, Calgary, AB, T2C 4V2 T: 905-333-0300 F: 905-333-1841  
**Hadrian Inc.**, 7420 Clover Avenue, Mentor, OH, 44060 T: 440-942-9118 F: 440-942-9618  
**Hadrian Inc.**, 3602 West Washington Street, Suite 200, Phoenix, AZ, 85009 T: 440-942-9118 F: 440-942-9618

08/2023

# Maintenance Procedure

## FOR POWDER COATED PAINTED FINISH

### **MAINTENANCE OF YOUR TOILET PARTITIONS SHOULD BE A PART OF YOUR REGULAR BUILDING PREVENTIVE MAINTENANCE PROCEDURE**

1. Tighten any screws that have become loose due to vibrational forces or attempted vandalism.
2. Check the top door pin to be sure it is flush with the top of the hinge.
3. Be sure the surfaces are dry after being cleaned and rinsed with clear water (when required).
4. Partitions exposed to severe humidity should be washed and dried frequently. If partitions are in a shower room, a coat of paste wax is recommended on painted surfaces.
5. Periodically, remove any dirt, grime or foreign matter with a soft cloth.
6. Where surfaces reveal spotting resulting from hand perspiration, soil, or grease, a thorough cleaning with warm water and a mild detergent (ie. Ivory Soap), followed by rinsing, and removal of excess moisture, will renew the clean even surface, providing a pleasant sanitary appearance. (Use of cleaning agents containing abrasives such as household cleaning powder, steel wool, and harsh detergents or acids ARE NOT RECOMMENDED).
7. To maintain the brilliance of hardware, these components can be periodically improved by an application of non-abrasive cleaner with a damp cloth.
8. Where additional gloss and protection is desirable, light applications of commercial liquid or paste waxes are highly recommended.
9. If your partitions have a continuous hinge, regular application of an LPS II or an industrial type, non-drying lubricant is recommended.

# LEED V4 CREDIT INFORMATION

## Building Product Disclosure and Optimization – Sourcing of Raw Materials

### Hadrian products can contribute toward Option 2. Leadership Extraction Practices (1 Point)

Use products that meet at least one of the responsible extraction criteria below for at least 25%, by cost, of the total value of permanently installed building products in the project.

- **Recycled content.** Recycled content is the sum of post-consumer recycled content plus one half the Pre-consumer recycled content, based on cost. Products meeting recycled content criteria are valued at 100% of their cost for the purposes of credit achievement calculation.

For credit achievement calculation, products sourced (extracted, manufactured, and purchased) within 100 miles (160 km) of the project site are valued at 200% of their base contributing cost. For credit achievement calculation, the base contributing cost of individual products compliant with multiple responsible extraction criteria is not permitted to exceed 100% its total actual cost (before regional multipliers) and double counting of single product components compliant with multiple responsible extraction criteria is not permitted and in no case is a product permitted to contribute more than 200% of its total actual cost.

### Hadrian's Recycled Content Documentation

LEED CATEGORY	DESCRIPTION	POWDER COATED TOILET PARTITIONS	STAINLESS STEEL TOILET PARTITIONS	SOLID PLASTIC TOILET PARTITIONS	LOCKERS BOOT RACKS
				CLASSB	
Recycled content	Post-consumer	36%	76%	0%	36%
	Pre-consumer	14%	15%	Minimum of 30%	14%
	In addition to the recycled content of the material above, the honeycomb / verticel core of powder coated toilet partitions, stainless steel toilet partitions and lockers contains 9% post-consumer and 9% pre-consumer recycled content.				
	Product weight Distribution	92% Steel 8% Honeycomb	92% Steel 8% Verticel	N/A	99% Steel 1% Honeycomb
Regional materials	Manufacturing / final assembly location	Burlington, ON	Burlington, ON	Mentor, ON	Calgary, AB
	Material extraction / harvest location	Material extraction harvest locations are not available.			

Hadrian's packaging materials (hardware boxes and locker end-caps) are made from 100% recycled material and our triple-ply, corrugated shipping container (USA) is 100% recyclable.

### VOLATILE ORGANIC COMPOUNDS (VOCs)

Hadrian products (metal and solid plastic) do not emit volatile organic compounds. Our powder coating process utilizes environmentally friendly technology as there is virtually no waste, energy consumption is low, and there are no solvent emissions.

### UREA FORMALDEHYDE

Hadrian products do not contain urea formaldehyde.

## BUILDING PRODUCT DISCLOSURE AND OPTIMIZATION – MATERIAL INGREDIENTS

### Option 1. Leadership Extraction Practices (1 Point)

Use at least 20 different permanently installed products from at least five different manufacturers that use any of the following programs to demonstrate the chemical inventory of the product to at least 0.1% (1,000 ppm).

- Health Product Declaration. The end-use product has a published, complete Health Product Declaration with full disclosure of known hazards in compliance with the Health Product Declaration Open Standard.

**Hadrian's Contribution** – Hadrian is working toward a Health Product Declaration (HPD). Release date TBA.